

# LED Panel Light- LNOVO DIMON

TECHNOLOGY

## INSTRUCTION MANUAL

Thank you for purchasing our LED panel light. Please read the below articles carefully to see how to use this product safely. Warning contents and attention contents related to product safety use, please be sure to follow it.

Part No.	Power	Input Voltage	Frequency	CCT	Ra
LNOVO-18W	18W	AC220-240V	50/60Hz	3000K/ 4000K/ 6500K	>80
LNOVO-26W	20W				
LNOVO-36W	36W				
LNOVO-48W	48W				
LNOVO-60W	60W				

### Attention

1. This panel light is non-waterproof, please use in dry location only.
2. Please keep the panel light away from any corrosive substance. When you clean it, please use dry cloth
3. Due to the panel lights are installed on high places, please ensure personal safety when you clean and fix them.

### Warning

- \* Make sure the distances between live part and metal part of LED panel can satisfy reinforced or double insulation.
- \* Luminaires not suitable for covering with thermally insulating material.
- \* This LED light is for indoor use only.
- \* The luminaire should only be installed by a qualified electrician.
- \* Before installation and maintenance of the light panel, please disconnect the power to prevent electric shock
- \* Before installation and maintenance, LED panel light must be operated by professional and technical personnel, non-professionals do not to remove the light panel.
- \* The light panel must be installed in an appropriate environment to work.  
In harsh environments may shorten the life or even damage the light panel
- \* For type Y attachments: If the external flexible cable or cord of this luminaire is damaged, it shall be exclusively replaced by the manufacturer or his service agent or a similar qualified person in order to avoid a hazard.



Correct disposal of this product  
This marking indicates that this product should not be disposed with other household wastes throughout the EU. To prevent possible harm to the environment or human health from uncontrolled waste disposal, recycle it responsibly to promote the sustainable reuse of material resources. To return your used device, please use the return and collection systems or contact the retailer where the product was purchased. They can take this product for environmental safe recycling.

### Recessed Installation

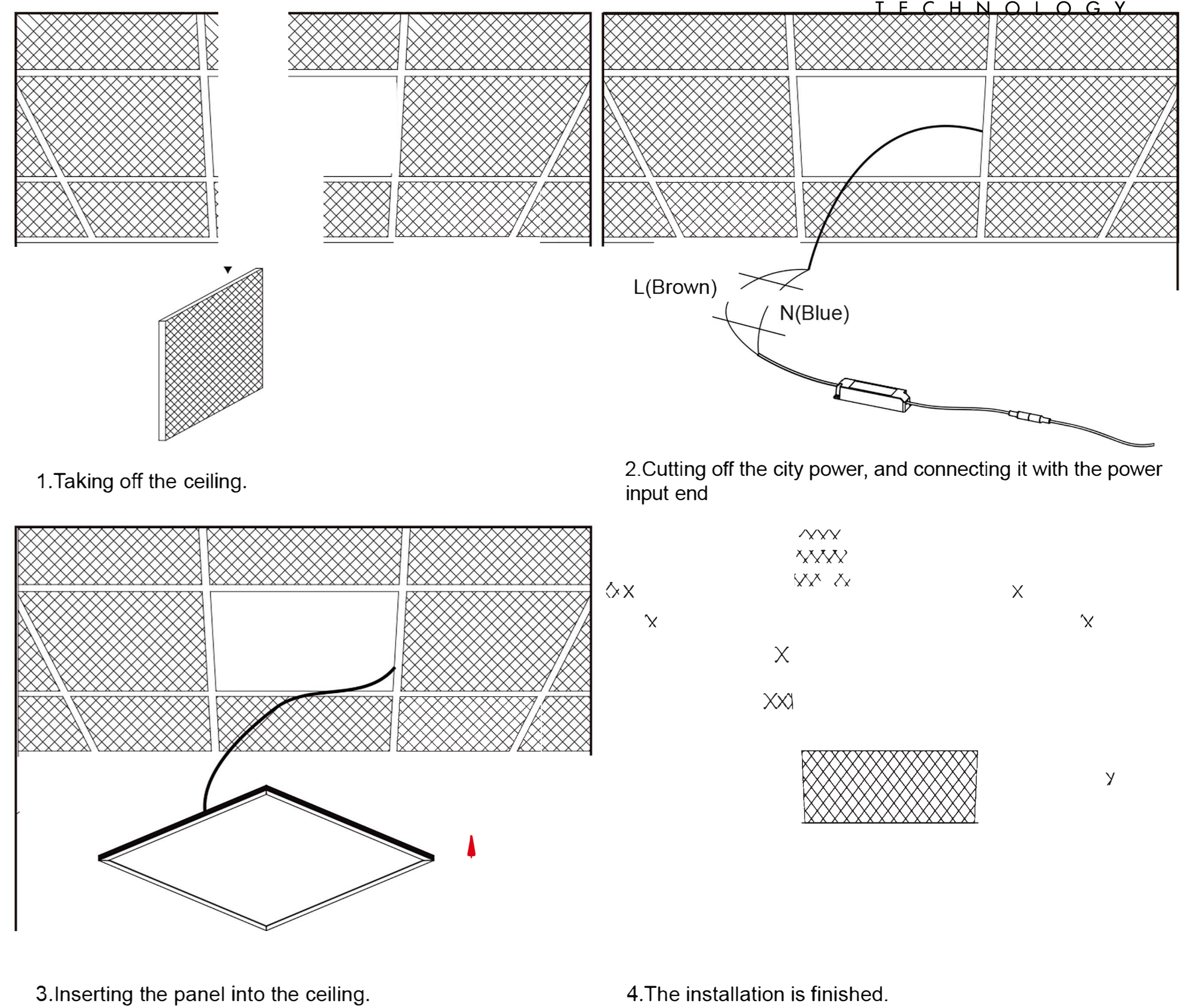

### Surface Mounted Installation

DIMON  
TECHNOLOGY

1. Make holes on the ceiling based on the position and size of the holes of surface mounted kits.

2. Connect the surface mounted kits by using screws.

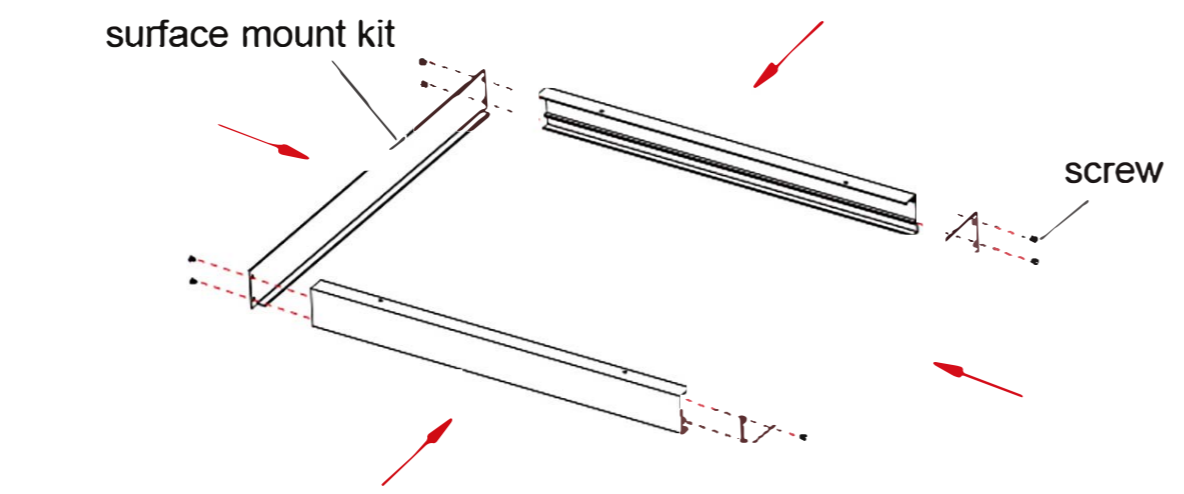
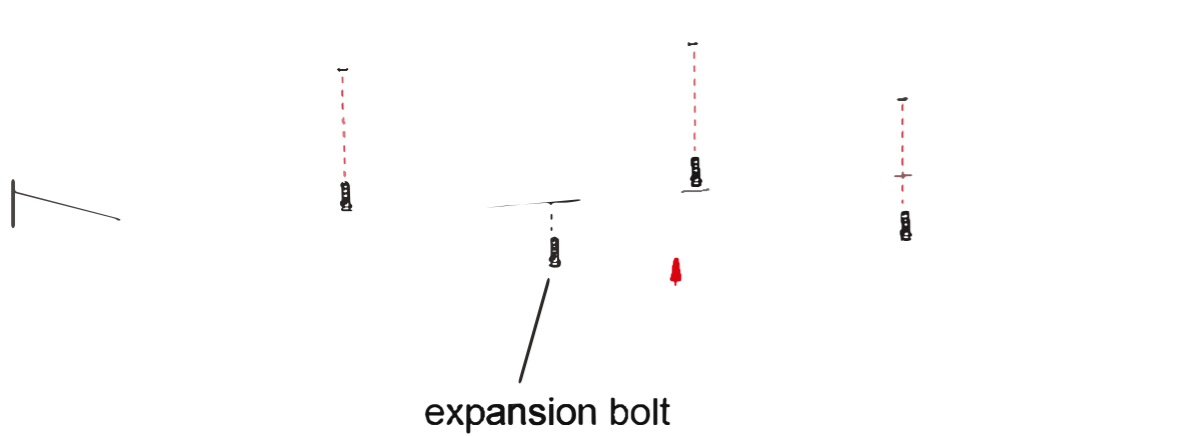

3. Fix the surface mounted frame on the ceiling by using screws.

4. Take off one part of the surface mounted frame as illustrated.

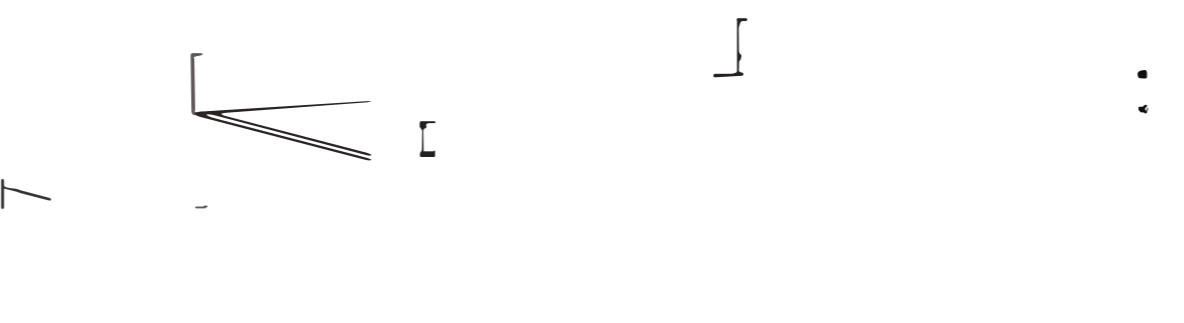

5. Insert the panel into the surface mounted frame.

6. Fix the surface mounted kits tightly.

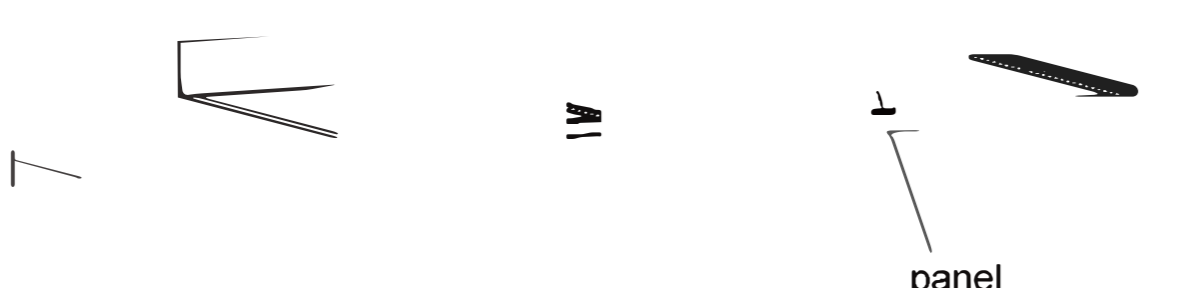

### Suspension kit Installation

DIMON  
TECHNOLOGY

1. Drill two holes in the ceiling, and put the anchors into hole, then insert the wire rope and screw.

2. Adjusting the hanging rope making the panel in a horizontal state.

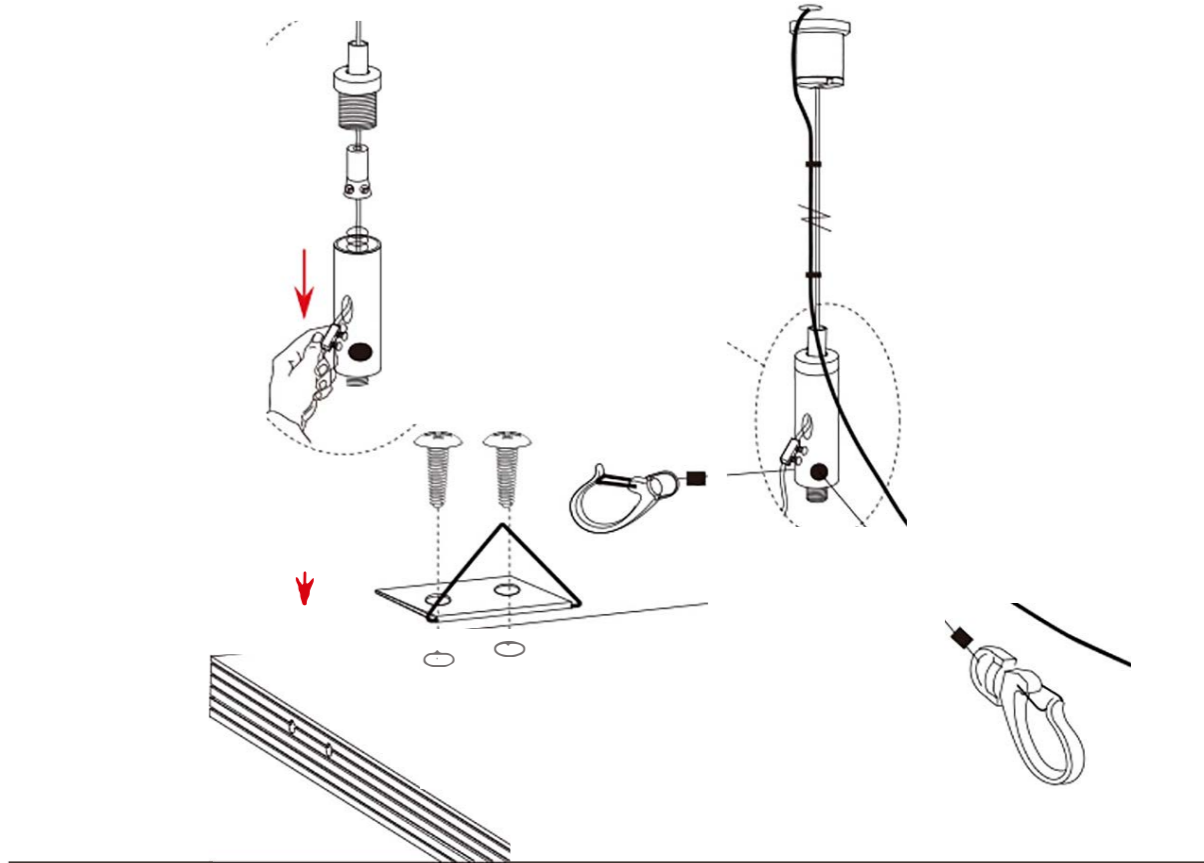
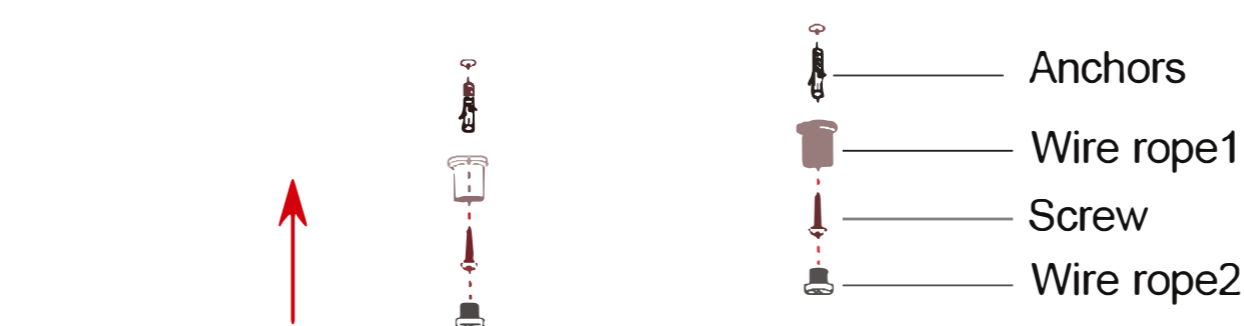

3. The installation is finished.

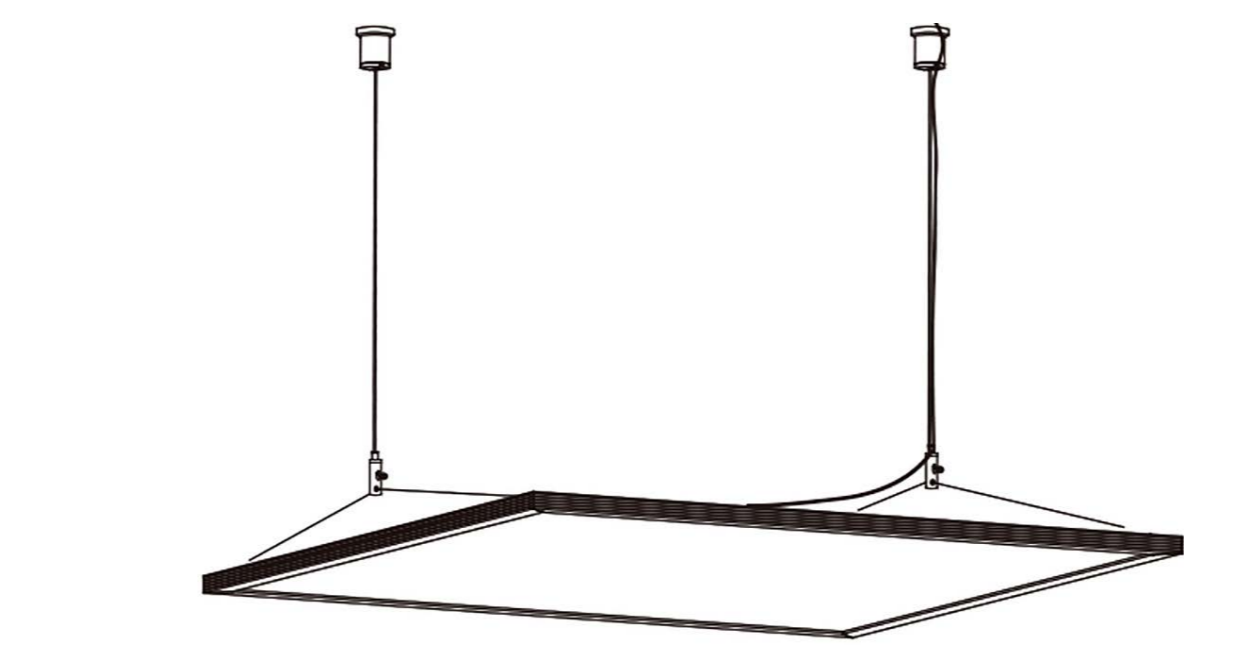

**Note: Suspending installation method is not suitable to be used for products with dimensions of 1195\*595mm.**  
295\*295/595\*295/595\*595/620\*620mm: 2pcs suspension kits needed for installation.  
1195\*295mm: 3pcs suspension kits needed for installation.

The Installation must be carried out by a qualified electrician.