

ENTE

Single and Double Exit Sign 3W IP65



Double-Side Exit Sign



Single-Side Exit Sign



Recessed Mounted Type



LED INDICATOR

- GREEN - FULLY CHARGED
- RED - CHARGING

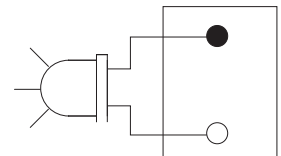





Testing Botton

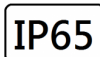

- **Automatic self-testing function to achieve the periodical test automatically.**
- **The objective for this series is to reduce the labor cost to push the test button manually to check the health of the exit sign.**
- **Every 28 days for function tests and every 52 weeks for duration tests**
- **A fault indicator will light on in case of failure of testing and will be removed by next successful auto-testing.**
- **Polycarbonate for complete body and under BS EN 60598-2-22 (850°C hot wire test) testing**

Technical Data

Luminaire Type-安裝方式/Tipo de luminaria	Recessed Mounted , Wall Mounted or Surface Mounted Type 嵌入式、壁掛式或表面安裝型 Tipo de montaje empotrado, montaje en pared o montaje en superficie
Dimension-尺寸-Dimensión	• Double side : W:118 x L:343 x H:210 mm • Single side : W: 118 x L: 352 x H: 80mm
Input Voltage-輸入電壓-Voltaje de entrada	AC200-240V 50/60Hz
System Mode 應急系統模式 Modo de sistema	• Maintained Type 長時式 Tipo mantenido
Power Consumption Max-燈具功率 Consumo de energía Max	• 3W
Charge Time 充電時間 Tiempo de carga	• <12 Hours or <24 Hours
Discharge Duration 放電時間 Duración de la descarga	>3 Hours
LED Life-LED壽命-La vida del LED	> 50000 hours
Color Temperature -色溫 Temperatura del color	6500K
Battery Type 電池類型 Tipo de batería	• 3.6V 1800mAH Ni-Cd
LED indicator Function LED指示燈功能 Indicador LED de función	• Green LED -Mains on/ No fault and Battery Charging 綠色 LED - 電源打開/無故障和電池充電 • Green Flash-Fast flash 3 hour duration test 綠閃-快閃3小時持續時間測試 • Red Flash-Battery fault/ Lamp fault/Duration test fault 紅色閃光-電池故障/燈泡故障/持續時間測試故障
Housing materials-外殼材料 Materiales de la carcasa	Polycarbonate 聚碳酸酯 Policarbonato -BS EN 60598-2-22 (850°C hot wire test)
Operating Temperature 工作溫度 Temperatura de funcionamiento	0°C - 50°C
Housing Color 外殼顏色 color de la carcasa	Matte white 啞光白色 Blanco mate
Ingress Protection-防護等級 Protección de ingreso	IP65 - (IEC 60529)
Environment-使用環境-medio ambiente	Outdoor
Comply Testing Standard 符合測試標準 Cumplir el estándar de prueba	IEC 60598-1:2020 & BSEN 60598-2-22:2014+A1:2020 at temperature of 850°C and IEC 60695-2-10:2013 BS EN 50200: 2015 (PH60) and Annex E of BS EN 50200: 2015 (a duration of survival time of 30 minutes) and one of the following standards: (i) BS EN 60702-1: 2002 +A1: 2015 & BS EN 60702-2: 2002 +A1: 2015 (ii) BS 7629-1: 2015 (Cat. Standard 60) (iii) BS 7846: 2015 (Cat. F2 for cables of overall diameter not exceeding 20mm) (b) BS 6387: 2013 Cat. CWZ. The test results from our measurement complied with the relevant sections of BS 5266-1:2016, BS EN 1838:2013 and relevant parts of BS EN 60598-2-22:2014+A1:2020 and regulation PPA / 104 (A) (5th Revision) of Fire Services Department specifications.
Certification-認證-Certificación	    

Technical Drawing

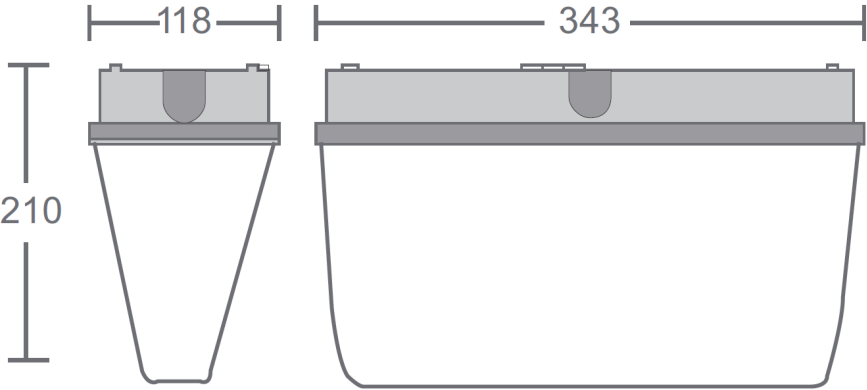

Double Side

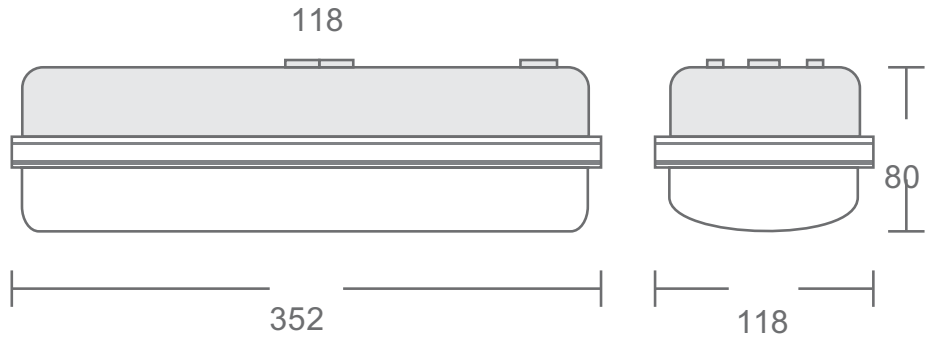

Single Side

Unit: mm

Legends



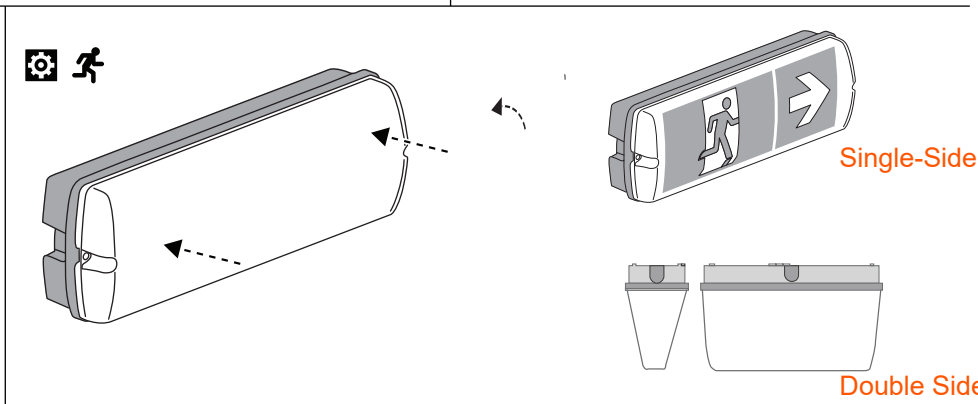
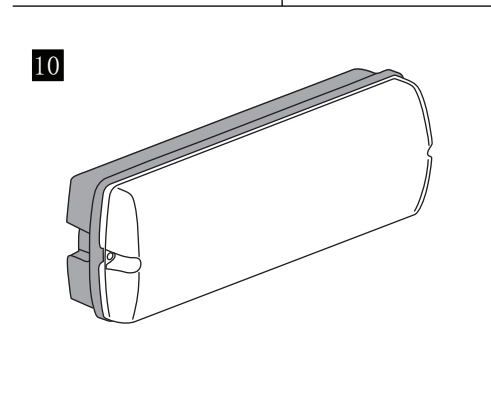
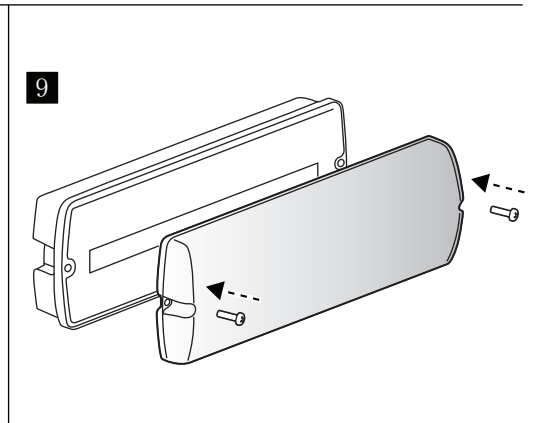
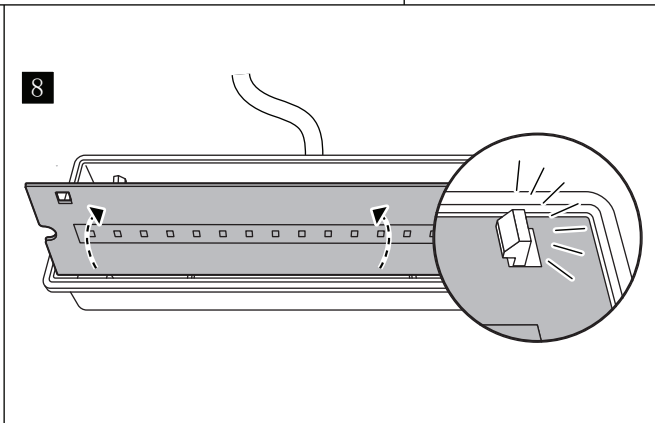
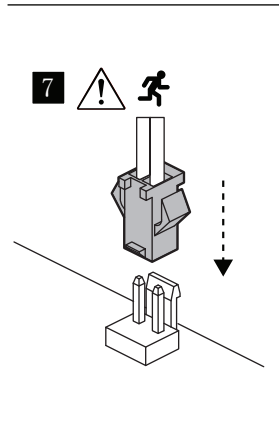
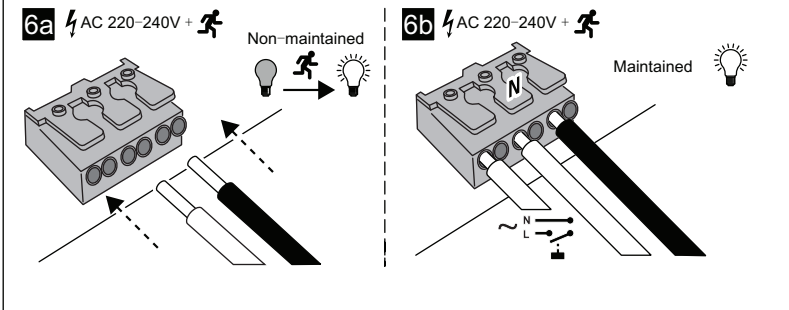
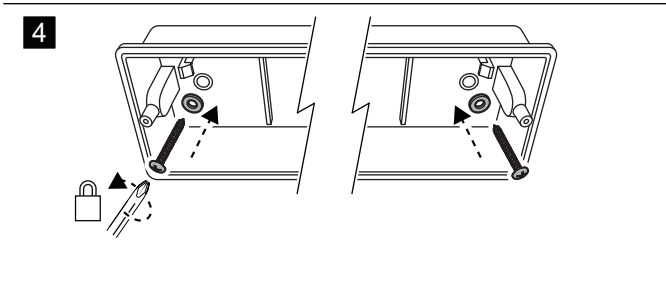
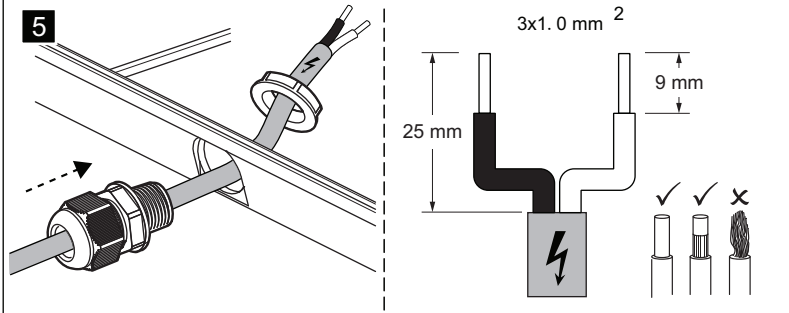
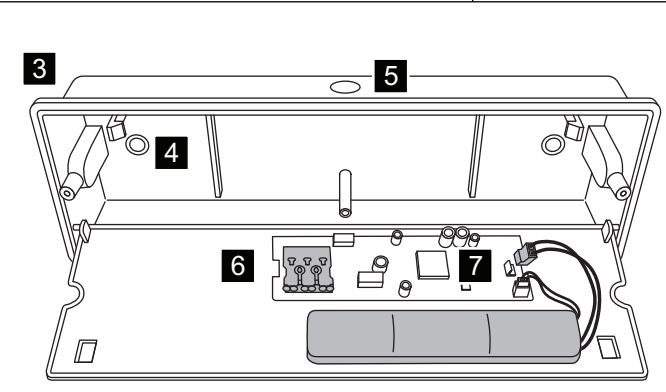
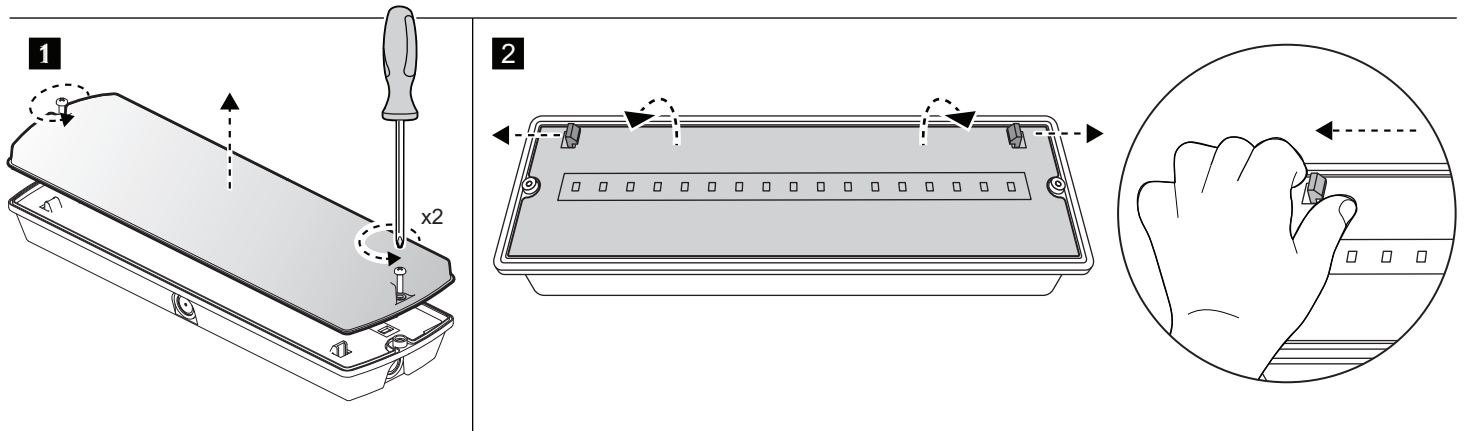

Instruction Manual for self test

Self-Test

Self-Test fittings perform a self-commissioning test at first power on. After charging for 12hours or 24 hours a full duration test (2 hours / 3 hours) is performed. Initial function and duration tests are randomly generated. After initial function and duration test finished, they are then performed in accordance with standard requirements (every 28 days for function tests and every 52 weeks for duration tests).

A single bi-colour indicator LED is fitted in all Self-Test products. This LED is clearly visible for manual inspection. It indicates the module status. The LED shows permanent green or flashing green when conditions are normal and flashing red if a fault condition is present.

Function test

A function test is a 2 minutes test that simulates a mains failure and checks the operation of the emergency light source from the battery supply.

The local indicator LED slow flashes green whilst the 2 minutes function test is in progress.

If there is a failure during a function test the local indicator LED changes to a flashing red.

Duration test

A duration test simulates a mains failure. It also checks the operation of the emergency light source from the battery supply for the rated duration of the module.

The local indicator LED fast flashes green whilst the duration test is in progress.

If there is a failure during a duration test the local indicator LED either changes to a permanent, or flashing red and the appropriate DALI status flag is set.

The battery is required to be fully charged before a duration test can be started.

The test button of the unit has the following functions

Test Button	Green LED	Status
Press for about 1s	Off	Emergency mode for 1 second
Press for about 5s	Slow flash	Function for 30 seconds
Press for about 7s	Fast flash	2 or 3 hour duration test
Press for about 10s		End the duration test

Please refer to following chart below for more complete description/fault indication.

	LED Status	Status
Green Solid	Mains on/ No fault	Battery Charging
Green Flash	Slow flash	Function for 2 minutes
	Fast flash	3 hour duration test
Red Flash	1 Flash	Battery fault
	2 Flash	Lamp fault
	3 Flash	Duration test fault