

LNOVO

18W-72W H:11mm EU UGR<19 IP20

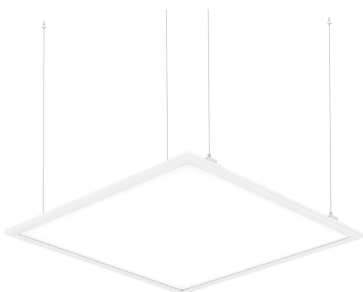

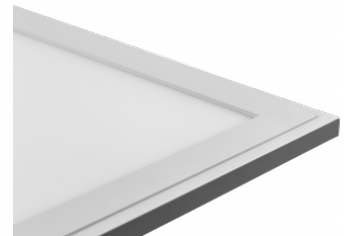





Opal Plate diffuser

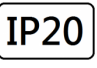

Suspended Mounted

- Recessed or surface mounted Diffused LED Luminaire with High Uniformity
- Microprismatic system to Low glare (UGR<19).
- White Painted Aluminium frame with reflective sheet (PET) and Opa Plate diffuser.

Technical Data

Luminaire Type-安裝方式 Tipo de luminaria	Recessed & Surface & Suspended Mounted 嵌入式, 明裝或吊裝 Empotrado y superficie y suspendido montado		
Power Consumption with LED Driver LED燈具包括LED驅動電源功率 Consumo de energía con controlador de LED	• 18W@ L: 295mm x W: 295mm • 28W@ L: 595mm x W: 595mm • 48W@ L: 595mm x W: 1195mm • 70W@ L: 595mm x W: 1195mm	26W@ L: 595mm x W: 295mm 36W@ L: 595mm x W: 595mm 60W@ L: 595mm x W: 1195mm	
Input Voltage / 輸入電壓/Voltaje de entrada	220-240V/AC 50/60Hz (with remote driver)		
LED Driver Type LED驅動款式 Tipo de controlador LED	Remote-type LED Driver--Constant Current LED Driver Refer to LED driver specification 請參閱LED驅動器規格 Consulte la especificación de controlador de LED 1. ON/OFF Switch AC220-240V 50/60HZ 2. 1-10V Dimming Driver AC220-240V 50/60HZ 3. Dali Dimming 1-100% Driver AC220-240V 50/60HZ		
LED Driver Features Constant Current LED Driver: 驅動特性-恆流LED驅動器 Funciones del controlador de LED	• POWER FACTOR : PF>0.95 • TOTAL HARMONIC DISTORTION: THD< 20% • Refer to LED Driver data sheet		
Control Protocol/控制協議/Protocolo de Control	• 1-10V / Dali / Dali2		
Light Source Brand-光源品牌-Fuente de luz de marca	SMD 4014 LED		
"Lumen Maintenance LM-80 Reported by TM-21"@ 25°C	L70 > 60,000 hrs		
LED Life-LED壽命-La vida del LED	>60,000 hours		
Color Temperature -色溫/Temperatura del color	3000K / 4000K / 5000K		
Color Rendering Index-顯色指數 Índice de reproducción cromática	>80 >90		
MacAdam Ellipses Binning 麥克亞當橢圓分級 Mac Adam binning ellipse	Standard Deviation Colour Matching < 3 SDCM 標準偏差配色< 3 SDCM Coincidencia de color estándar Desviación < 3 SDCM		
Beam Angle光束角/ángulo de haz	110 °		
Luminaire Efficacy燈具效率 La eficacia de la luminaria	• 100 Lm/w(3000K)	120 Lm/w(4000K)	120 Lm/w(5000K)
LED Source Luminous EfficacyLED光源光效 Fuente luminosa LED Eficacia	• 140 Lm/w(3000K)	160 Lm/w(4000K)	160 Lm/w(5000K)
Housing materials 外殼材料 Materiales de la carcasa	Aluminum Alloy Trim and Opal Polycarbonate diffuser 鋁合金框片和乳白PC擴散器 PMMA導光板) Embellecedor de aleación de aluminio y difusor de policarbonato opalino		
Housing Color 外殼顏色 color de la carcasa	White (RAL9016) Painted Aluminium frame and Opal Acrylic Diffuser 白色(RAL9016)鋁框和 亞克力擴散板 Marco de aluminio pintado blanco (RAL9016) y difusor acrílico opalino		
Ingress Protection-防護等級 Protección de ingreso	IP20		
Operating Temperature Range / 工作溫度範圍 Rango de temperatura de funcionamiento	-20 °C / +50 °C		
Operating Humidity / 工作濕度/Humedad de funcionamiento	0~90%, non-condensing-不結霜sin condensación		
Dimension尺寸 Dimensión	• L: 295mm x W: 295mm x H: 11 mm (H: 39mm with Remoted LED Driver) / 1.0kg • L: 595mm x W: 295mm x H: 11 mm (H: 39mm with Remoted LED Driver) / 1.6kg • L: 595mm x W: 595mm x H: 11 mm(H: 39mm with Remoted LED Driver) / 2.9kg • L: 1195mm x W: 295mm x H: 11 mm(H: 39mm with Remoted LED Driver) / 2.9kg • L: 1195mm x W: 595mm x H: 11 mm (H: 39mm with Remoted LED Driver) / 5.6 kg		
Comply Testing Standard 符合測試標準 Cumplir el estándar de prueba	LED Luminaries: LVD: IEC/EN 60598-1;EN / IEC/EN 60598-2-1;IEC62471;IEC/EN 62031; IEC/EN 62493 ; IEC/EN 62471 (Risk Group 1) LED Driver: IEC/EN 61347-1; IEC/EN 61347-2-13; IEC/EN 62384; IEC/EN 61000-3-2; IEC/EN 61000-3-3;IEC/EN61574;EN 55015 ; IEC /EN 62384		
Certification-認證-Certificación	     		

Project	Fixture#	Date
		Firm



Ordering Information

Choose the option that suits your need and write its corresponding code on the appropriate line to form the product code.

Example product code: [LNOVO-60W-N-R](#)

LNOVO - - - - -
POWER CONSUMPTION
LED DRIVER TYPE
COLOR TEMPERATURE
FIXTURE MOUNTING TYPE

POWER CONSUMPTION		LED DRIVER TYPE		COLOR TEMPERATURE		FIXTURE MOUNTING TYPE	
Code	Description	Code	Description	Code	Description	Code	Description
18W	18W@L:295mm x W:295mm	DA	DALI Dimming	D	5000K	R	Recessed Mounted Type
26W	26W@L: 595mm x W:295mm	ZI	ON/OFF Switch	W	3000K	S	Surface Mounted Type
36W	36W@L: 595mm x W:595mm	AN	Analog 0 -10V Dimming	N	4000K	P	Pendant Mounted Type
48W	48W@ L:595mm x W:1195mm	EM	Emergency Battery Back Up 2 hour or 3 hours				
60W	60W@ L:595mm x W:1195mm						
72W	72W@ L:595mm x W:1195mm						

Technical Drawing

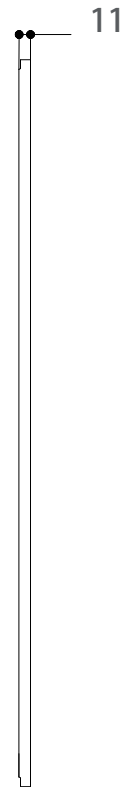
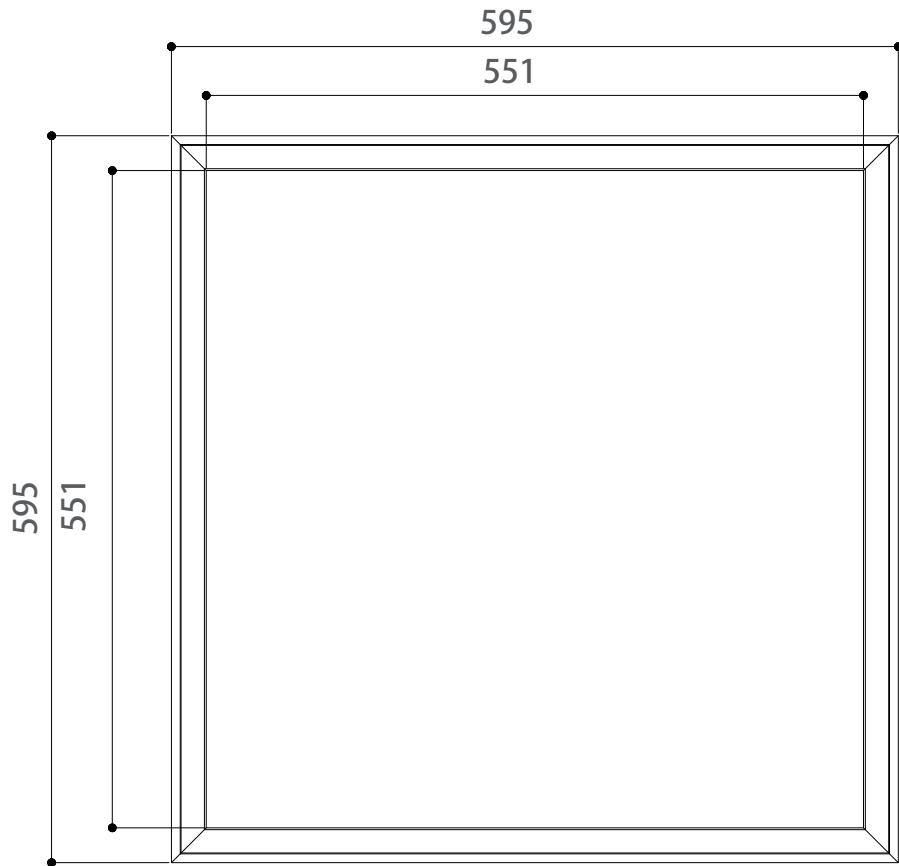

Unit: mm

BEAM ANGLE

110°

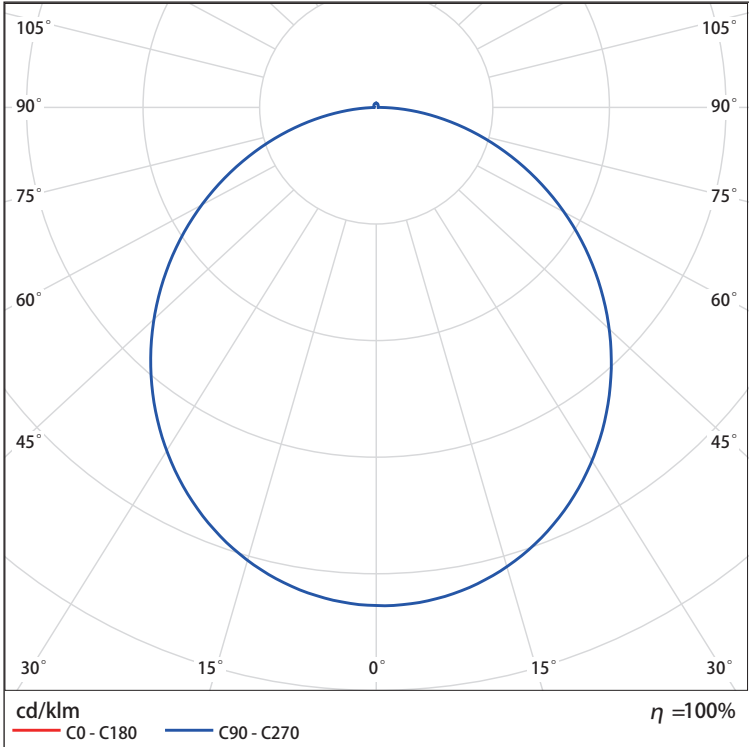

Installation steps:

Recessed Installation

1. Install panel light on the ceiling board. (Picture 10, 11)

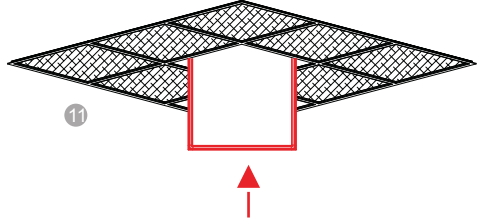
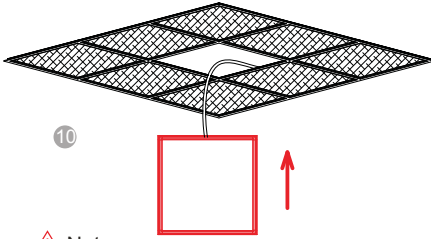

Note:

- 1> Turn over panel light with 45° and put it on the ceiling board.
Do not press or pass through ceiling board strongly.
- 2> Carefully install it so that it get a good lighting effect.
- 3> Consider the installation specification(Size) before choose the recessed panel light.
- 4> Do not directly put the driver on the back-plate of panel light.

2. Take the lighting surface of panel light down. (Picture 12 and 13)

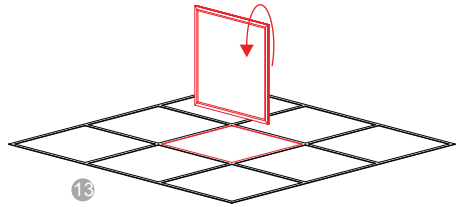
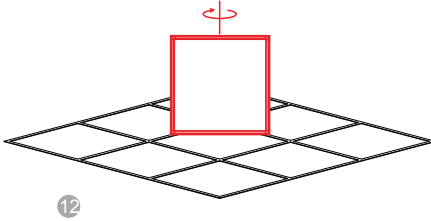

3. Aligning the site of panel light and ceiling board and finish the installation. (Picture 14, 15)

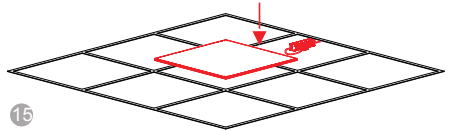
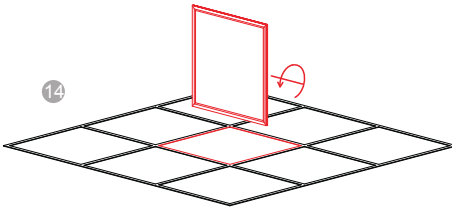

4. The picture for finishing the installation and light it. (Picture 16)

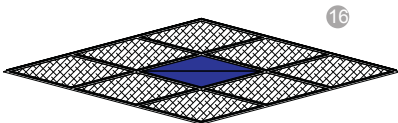

Importance:

- 1> Finish the installation, check the connectors.
- 2> Check all connectors' "+" and "-" poles to be connected correctly.
- 3> Check the sites with screws are locked tightly or not.

5. Remark: If panel light will be suspended, you need to take the suspending position of each size into consideration as follows:

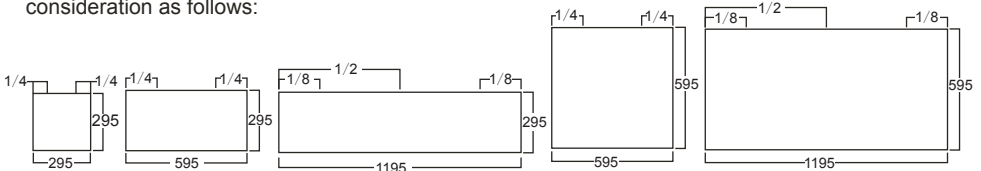

Installation steps:

Suspended Installation

1. Fix the corner accessories on the panel light. (Picture 17,18,19)

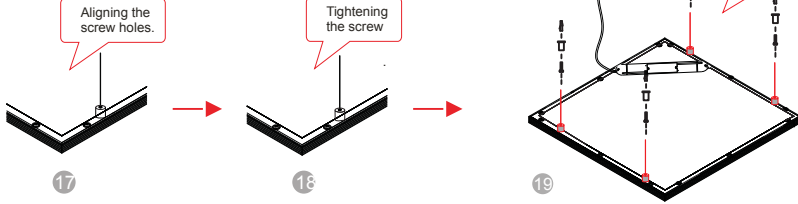

Note:

- 1> Put a soft cushion under the panel light to protect when fix the corner accessories.
- 2> Carefully install it so that it gets a good lighting effect.
- 3> Do not apply a lot of pressure to twist the screws and make the panel light broken.

2. Fix the corner accessories on the ceiling board. (Picture 20,21,22)

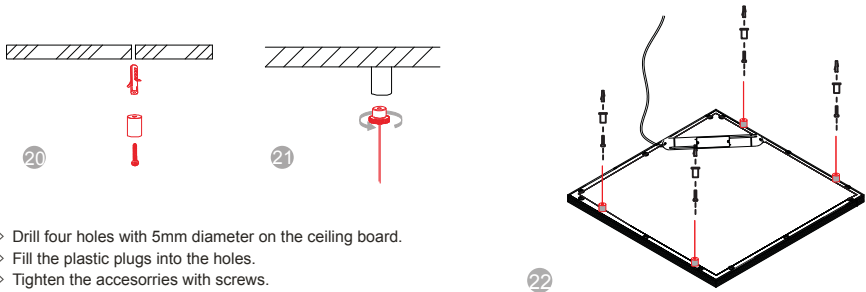

- 1> Drill four holes with 5mm diameter on the ceiling board.
- 2> Fill the plastic plugs into the holes.
- 3> Tighten the accessories with screws.

3. Connect the input end of power supply to AC. (picture 23)

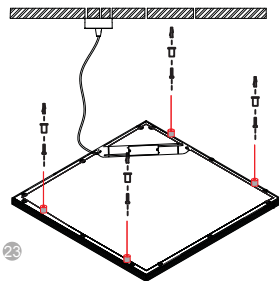

4. The picture for finishing the installation and light it. (Picture 24)

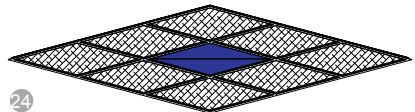

Important Notice:

- 1> Finish the installation, check the connectors.
- 2> Check all connectors' "+" and "-" poles to be connected correctly.
- 3> Check the sites with screws are locked tightly or not.