

## STRAAP-LED MODULAR

12LEDs 2835 SMD Light box bar



- The light source adopts high-quality 2835 large-size chip, with high brightness, long life and low attenuation;
- Using a special secondary light distribution lens, it is suitable for light boxes no less than 3cm thick and produces uniform light;
- Using aluminum substrate technology, heat dissipation is more direct and rapid;
- Roller shutter style, easy to arrange, easy and neat installation;
- The PCB has fixed holes for easy positioning;
- The light strip supports one light and one cut, and can be cut arbitrarily according to requirements;

# STRAAP-LED MODULAR

12LEDs 2835 SMD Light box bar

**DIMON**  
TECHNOLOGY

## Technical Data

Luminaire Type- 安裝方式 Tipo de luminaria	Surface Mounted Type 明裝式燈具 Superficie Tipo Montado
Dimension-尺寸-Dimensión Pitch -間距-Tono	• L:950 x W: 17 x H:6.2 mm • 80mm
QTY of LEDs-燈珠數量-CANT de LEDs	12 pcs LEDs
Input Voltage-輸入電壓-Voltaje de entrada	DC12V
Power Consumption Max-燈具功率 Consumo de energía Max	12W
LED Driver Type LED驅動款式 Tipo de controlador LED	Remote-type LED Driver--Refer to LED driver specification 請參閱LED驅動器規格 Consulte la especificación de controlador de LED 1. ON/OFF Switch AC220-240V 50/60Hz 2. ELV Dimming Driver (5-100%) AC 100-120V 50/60Hz or AC 200-240V 50/60Hz 3. 0-10V Dimming Driver AC100-240V 50/60Hz 4. Dali Dimming Driver AC100-240V 50/60Hz 5. DMX Driver AC100-240V 50/60Hz 6. RDM Driver AC100-240V 50/60Hz
Control Protocol-控制協議 Protocolo de Control	0-10V / Dali / DMX 512 / RDM / ZIGBEE Wireless Control
Beam Angle-光束角ángulo de haz	170°
Light Source Brand-光源品牌-Fuente de luz de marca	SMD 2835 Epistar
LED Life-LED壽命-La vida del LED	>60,000 hours
Color Temperature -色溫 Temperatura del color	2700K / 3000K / 4000K / 5000K / 6500K 12000K 14000K
Color Rendering Index-顯色指數 Índice de reproducción cromática	> 80 @ 2700K / 3000K / 4000K / 5000K / 6500K
MacAdam Ellipses Binning 麥克亞當橢圓分級 Mac Adam binning ellipse	Standard Deviation Colour Matching < 3 SDCM 標準偏差配色 < 3 SDCM Coincidencia de color estándar Desviación < 3 SDCM
Luminaire Flux 光通量 Flujo de luminarias	110 Lm/w(2700K), 110Lm/w(3000K), 120Lm/w(4000K), 130 Lm/w(5000K), 130 Lm/w(6500K), 130 Lm/w(1200K), 130 Lm/w(1400K),
Housing materials-外殼材料 Materiales de la carcasa	Aluminum PCB and PMMA Lens 鋁 PCB 和 PMMA 透鏡
Housing Color外殼顏色color de la carcasa	Milky乳白色Milky
Ingress Protection-防護等級 Protección de ingreso	IP20
Comply Testing Standard 符合測試標準 Cumplir el estándar de prueba	LED Luminaires: IEC 60598-1 / IEC 60598-2-2 / Photometric data-IES format LED Driver: EN 55015 / IEC 61000-3-2 / IEC 61347-1 / IEC 61347-2-13 / IEC 61547
Certification-認證-Certificación	

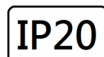

Project	Fixture#	Date
		Firm

## Ordering Information

Choose the option that suits your need and write its corresponding code on the appropriate line to form the product code.

Example product code: [STRAAP-12W](#)

STRAAP- 12W  
Power Consumption

PowerConsumption	
Code	Description
12W	12W



# BEAM ANGLE

170°

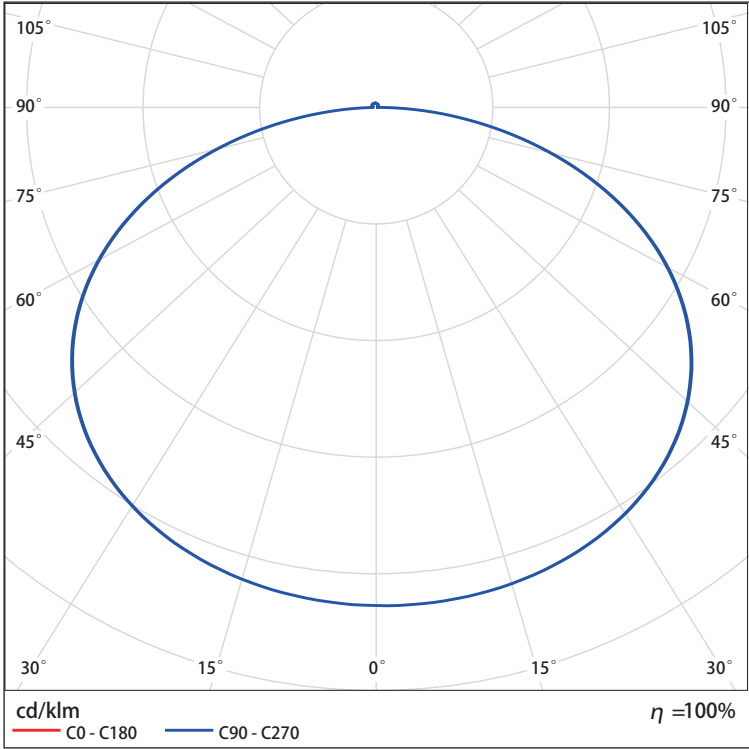

# Technical Drawing

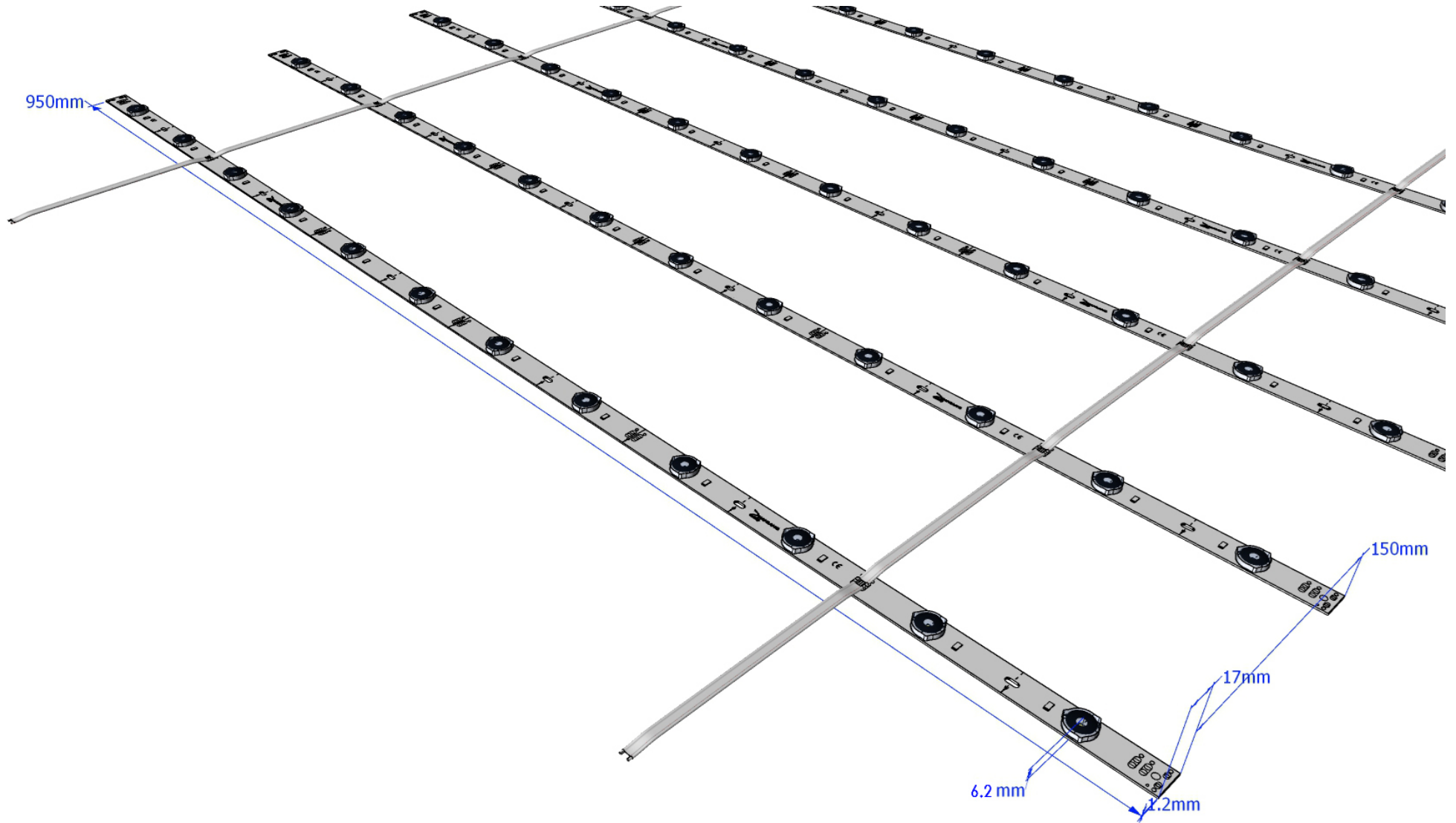

Unit: mm

# Electronic diagram

- Power supply instructions:
  1. The power supply needs to be grounded and protected against leakage. If the power supply is installed outside the light box, an additional switch box is required to place the power supply.
  - The power supply should be installed as close to the light bar as possible, the distance should not exceed 10 meters, and copper of 2.5mm or more must be used. The core power supply line is used to supply power to avoid the decrease in the brightness and uniformity of the light bar due to voltage drop;
  - The load of the power supply is controlled at 80% of its rated power. If a high-power power supply is used, the load (lamps) must be distributed as evenly as possible among each Load node (terminal block);
  - When installing lamps, do not operate them with power on to avoid damage to people and lamps due to short circuit or leakage;
  - Make sure the connections are correct before powering on. Once you find that the lamps do not light up, flicker, or even risk If there are any abnormal situations such as smoke, the power must be cut off immediately and troubleshooting must be carried out.

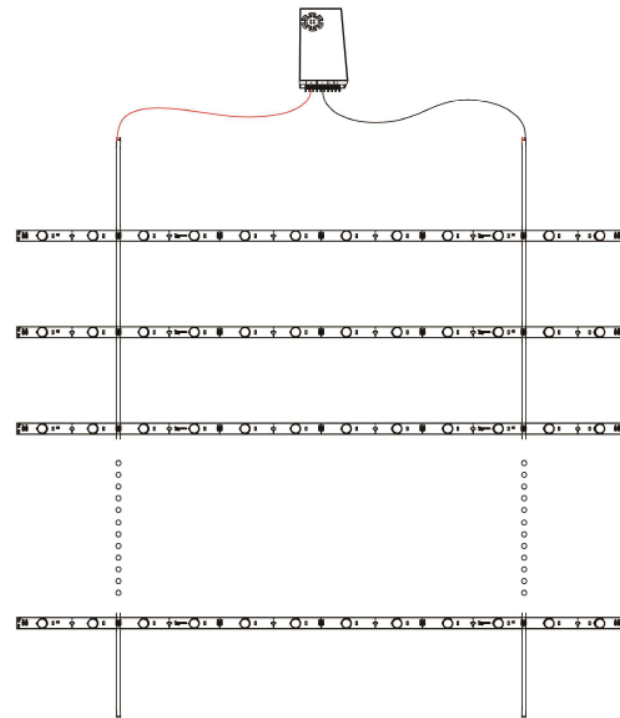
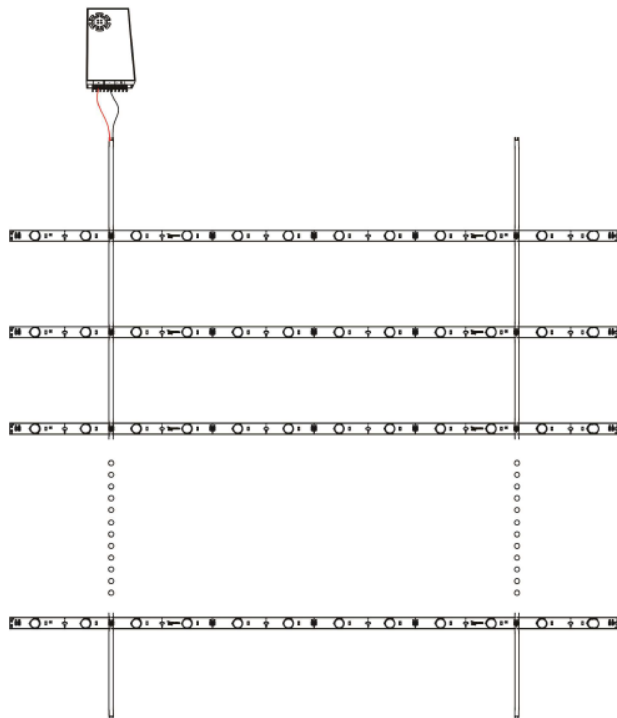

Unit: mm

# Installation

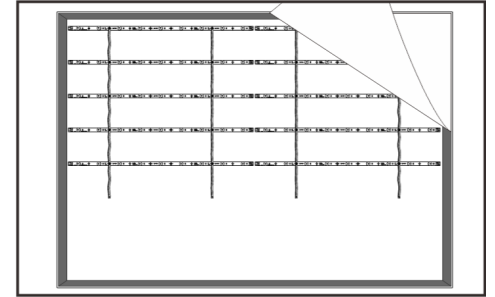
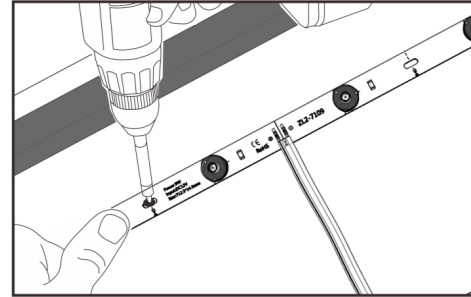
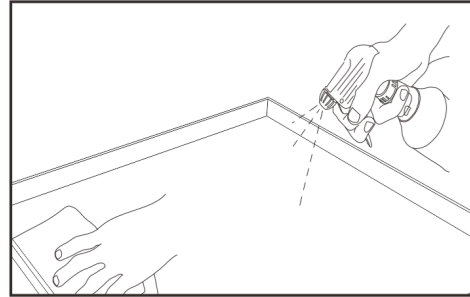
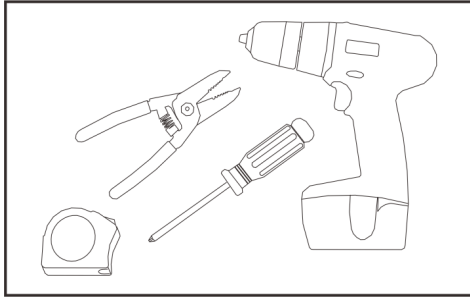

Light Bar Layout Solution	Light box Deep (mm)	Line spacing (mm)	Qty per square meter (PCS)	(lux)
<b>Recommend</b>	<b>60</b>	<b>100</b>	<b>10</b>	<b>3300~3800</b>
<b>A</b>	<b>40</b>	<b>80</b>	<b>12</b>	<b>4500-5000</b>
<b>B</b>	<b>80</b>	<b>150</b>	<b>6</b>	<b>2200-2500</b>
<b>C</b>	<b>100</b>	<b>150</b>	<b>6</b>	<b>2000-2200</b>
<b>D</b>	<b>120</b>	<b>150</b>	<b>6</b>	<b>1800-2000</b>

**Note: The above data are white UV soft film screen tests, the light transmittance is 55%; the color temperature of the test product is 9000~12000K;**

Unit: mm