

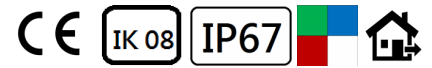



WEER S

Dia 38 / 52 / 64 / 80 / 100mm

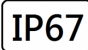

316 stainless steel faceplate, high pressure die-cast housing, surface with electrostatic plastic coating.
Lampshade adopts high strength toughened glass, resist the impact and friction.
Adopt American CREE original LED light source, high flus output, excellent consistency of light color.

Technical Data

Installation method / 安裝方式 metodo de instalacion	Recessed In-Ground Type 內嵌式地埋燈 Empotrada en el suelo del Tipo
Power Consumption Max 燈具功率 Consumo de energia Max	1W 2W @ Dia 38 x H 60 / 75 mm 2W 3W @ Dia 52 x H 75 mm 3W 4W 5W @ Dia 64 x H 74 mm 5W 6W 7W @ Dia 80 x H 85 mm 8W 9W 10W @ Dia 100 x H 115 mm
Input Voltage or Current / 輸入電壓或電流 Voltaje o corriente de entrada	350mA / 500mA / 700mA DC24V DC DC24V DC + DMX512 Decoder 220V AC
LED Driver Type LED驅動款式 Tipo de controlador LED	Remoted-type LED Driver--Refer to LED driver specification 請參閱LED驅動器規格 Consulte la especificación de controlador de LED 1. ON/OFF Switch AC220-240V 50/60HZ 2. ELV Dimming Driver (5-100%) AC 220-240V 50/60Hz or AC 200-240V 50/60HZ 3. 0/1-10V Dimming Driver AC220-240V 50/60HZ 4. DALI Dimming Driver AC220-240V 50/60HZ 5. DMX Driver AC220-240V 50/60HZ 6. RDM Driver AC220-240V 50/60HZ
Control Protocol控制協議Protocolo de Control	0/1-10V / DALI / DMX 512 / RDM / ZIGBEE Wireless Control
Beam Angle光束角ángulo de haz	5° 10° 12° 20° 25° 40° 60°
Light Source Brand/光源品牌 Fuente de luz de marca	Cree / Osram
"Lumen Maintenance LM-80 Reported by TM-21"	L70(10k) > 54,000 hrs
LED Life/LED壽命 La vida del LED	>100,000 hours
Color Temperature / 色溫 /Temperatura del color	2700K / 3000K / 4000K / 5000K / 6500K Color : RED , GREEN ; BLUE, YELLOW
Color Rendering Index/顯色指數 Índice de reproducción cromática	>80 >90
MacAdam Ellipses Binning 麥克亞當橢圓分級 Mac Adam binning elipse	Standard Deviation Colour Matching < 3 SDCM 標準偏差配色 < 3 SDCM Coincidencia de color estándar Desviación < 3 SDCM
Luminaire Efficacy 燈具效率 La eficacia de la luminaria	Transparent Tempered Glass 50 Lm/w(2700K), 60 Lm/w(3000K), 70 Lm/w(4000K), 70 Lm/w(5000K), 70Lm/w(6500K), 40Lm/w RED , 50 Lm/w GREEN ; 20Lm/w BLUE, 40Lm/w YELLOW
LED Source Luminous Efficacy LED光源光效 Fuente luminosa LED Eficacia	120 Lm/w(2700K), 130 Lm/w(3000K), 140 Lm/w(4000K), 140Lm/w(5000K), 140 Lm/w(6500K), 90Lm/w RED , 100 Lm/w GREEN ; 45Lm/w BLUE, 90Lm/w YELLOW
Housing materials/外殼材料 Materiales de la carcasa	Die cast aluminium, Tempered Glass with #316 Stainless Steel Cover 壓鑄鋁, 乳白或透明鋼化玻璃和#316不銹鋼面蓋 Aluminio fundido, vidrio templado lechoso o transparente con cubierta de acero inoxidable n.º 316
Housing Color/ 外殼顏色 Color de la carcasa	#316 Stainless Steel Cover #316不銹鋼面蓋 # 316 de la cubierta de acero inoxidable #316 Stainless Steel Chrome Black #316不銹鋼鉻黑 # 316 Acero inoxidable Cromo Negro
Operating Temperature Range / 工作溫度範圍 Rango de temperatura de funcionamiento	-20 °C / +50 °C
Operating Humidity -工作濕度 Humedad de funcionamiento	0~90%, non-condensing-不結霜 sin condensación
Ingress Protection/ 防護等級 Protección de ingreso	IP67
Mech impact protection 機械衝擊保護 Protección contra impactos mecánicos	IK08
Dimension-尺寸-Dimensión	Refer to Drawing 參考圖紙 Consulte el dibujo
Comply Testing Standard 符合測試標準 Cumplir el estándar de prueba	LED Luminaries: LVD: IEC 60598-1; IEC 60598-2-1; IEC62471; IEC 62031; IEC62471, ROHS TM21-L70 LED Driver: IEC/EN 61347-1; IEC/EN 61347-2-13; IEC/EN 62384; IEC/EN 61000-3-2; IEC/EN 61000-3-3; IEC/EN61574; EN 55015 ; IEC /EN 62384
Certification-認證-Certificación	    

Beam Angle

5°

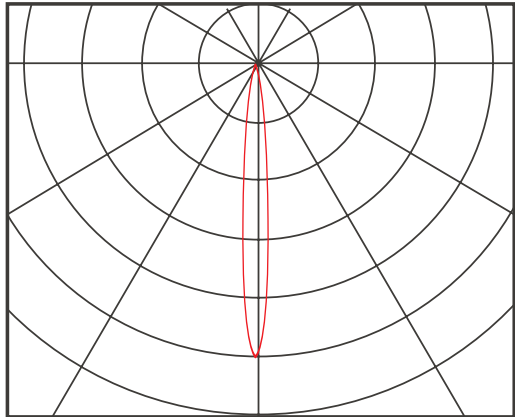

10°

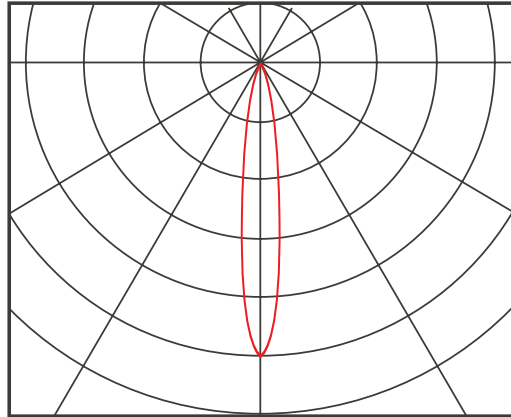

12°

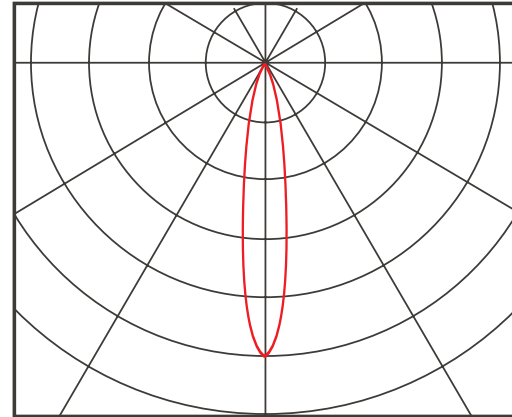

20°

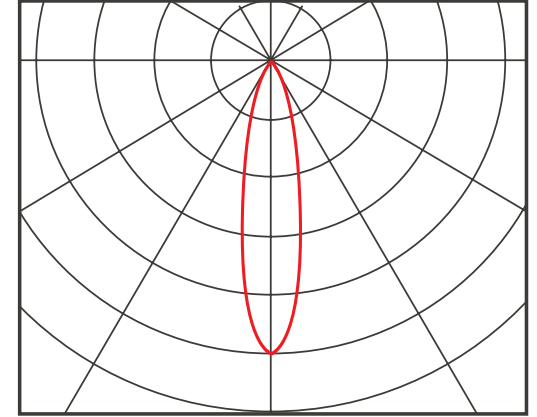

25°

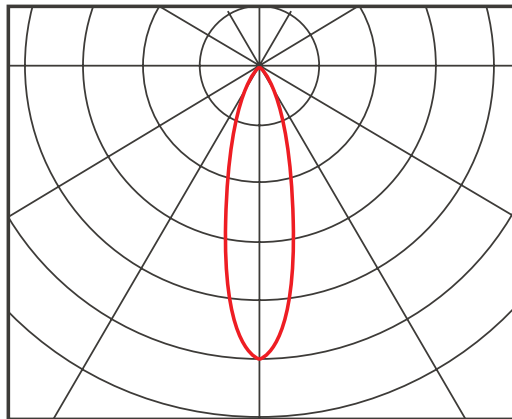

40°

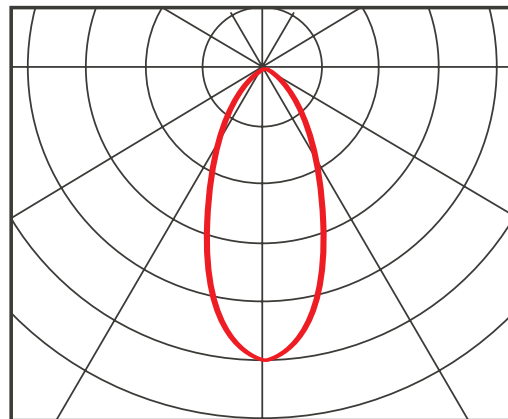

60°

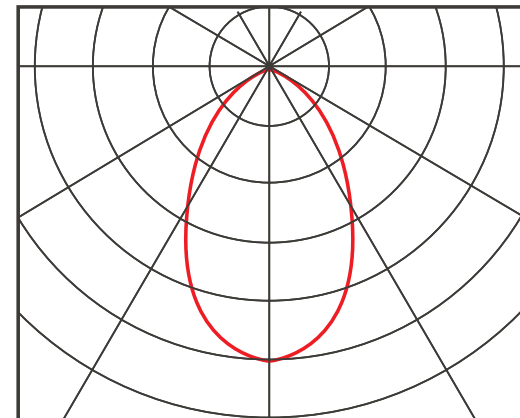

Technical Drawing

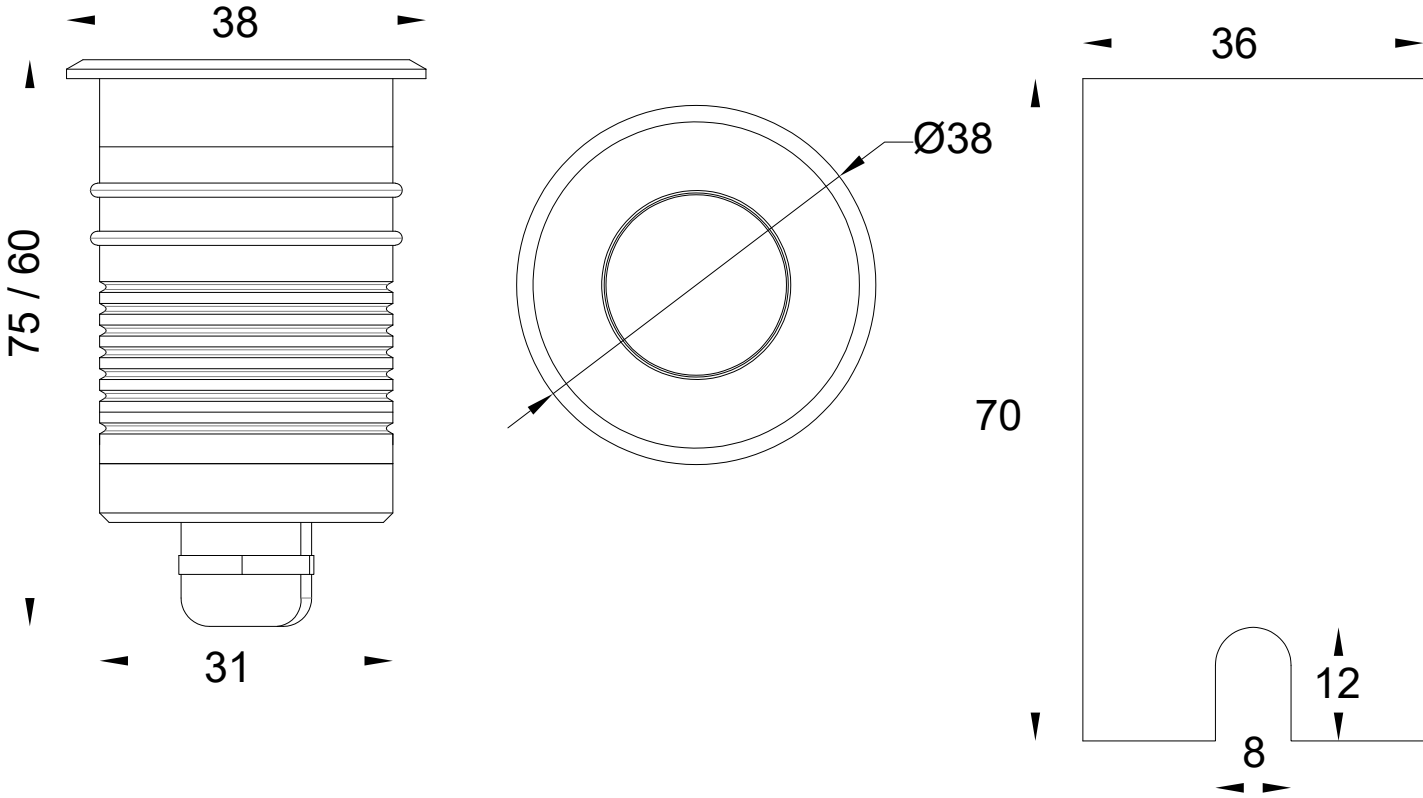

Unit: mm

Technical Drawing

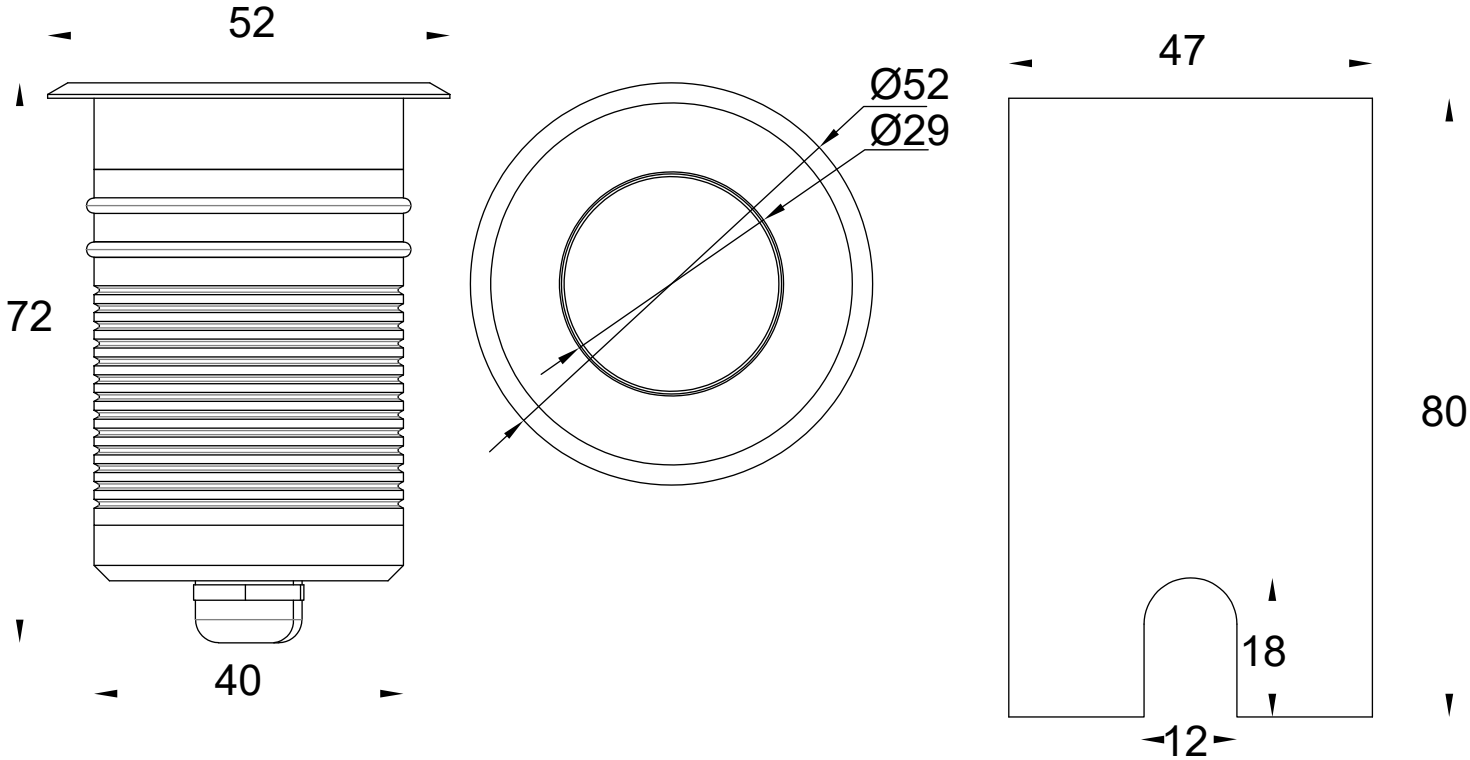

Unit: mm

Technical Drawing

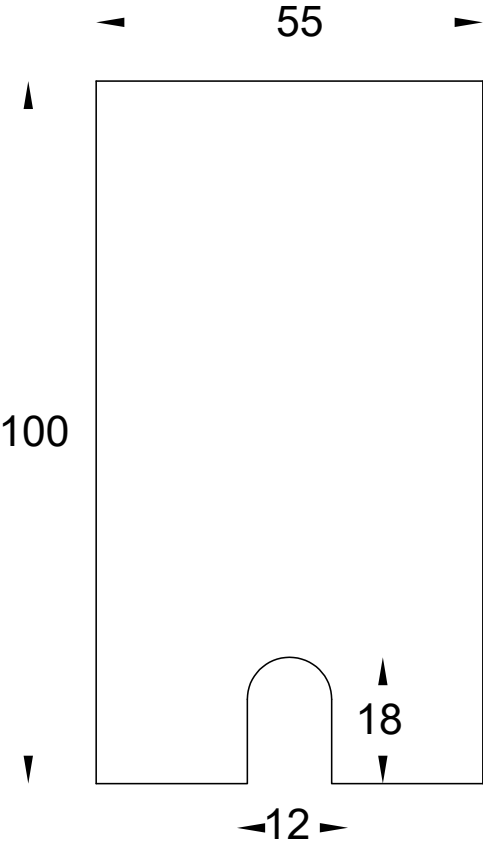
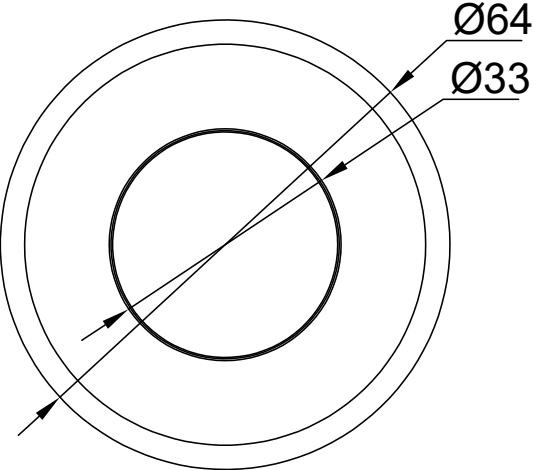
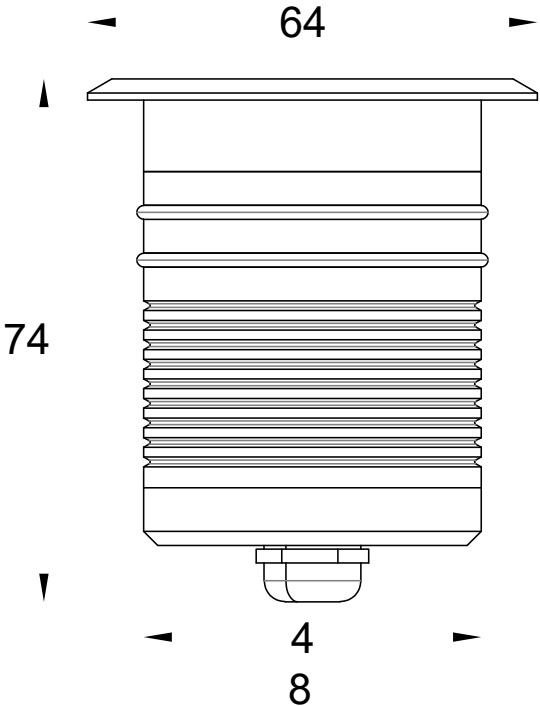

Unit: mm

Technical Drawing

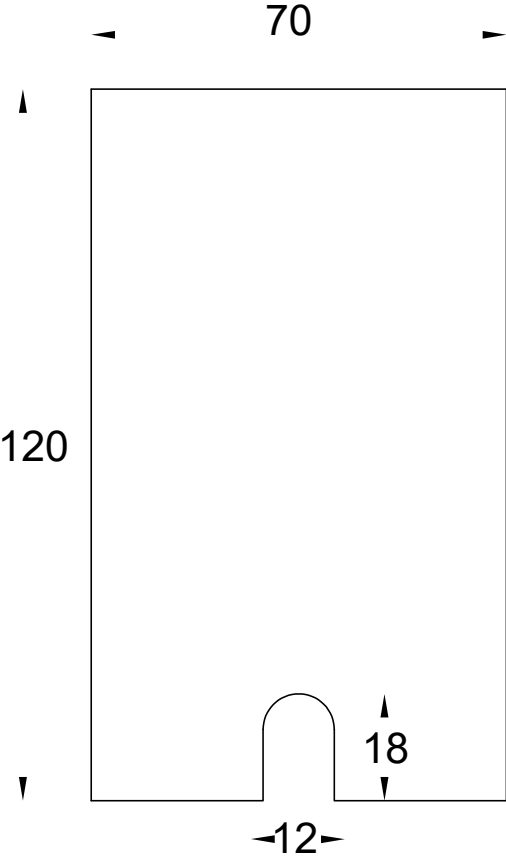
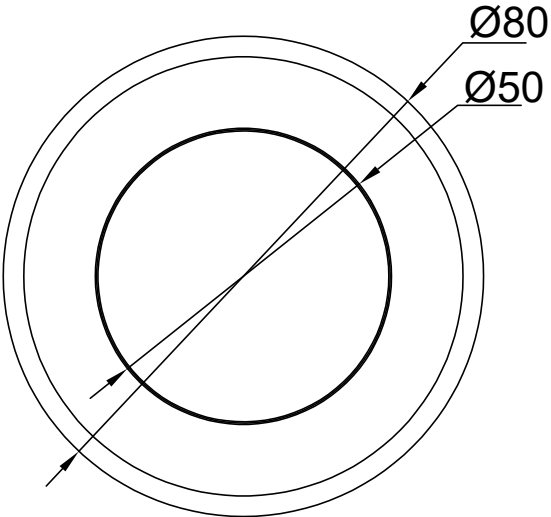
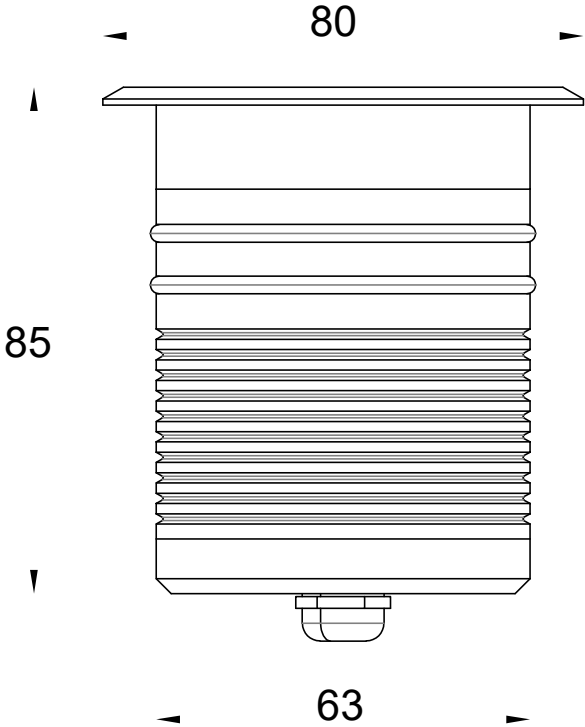

Unit: mm

Technical Drawing

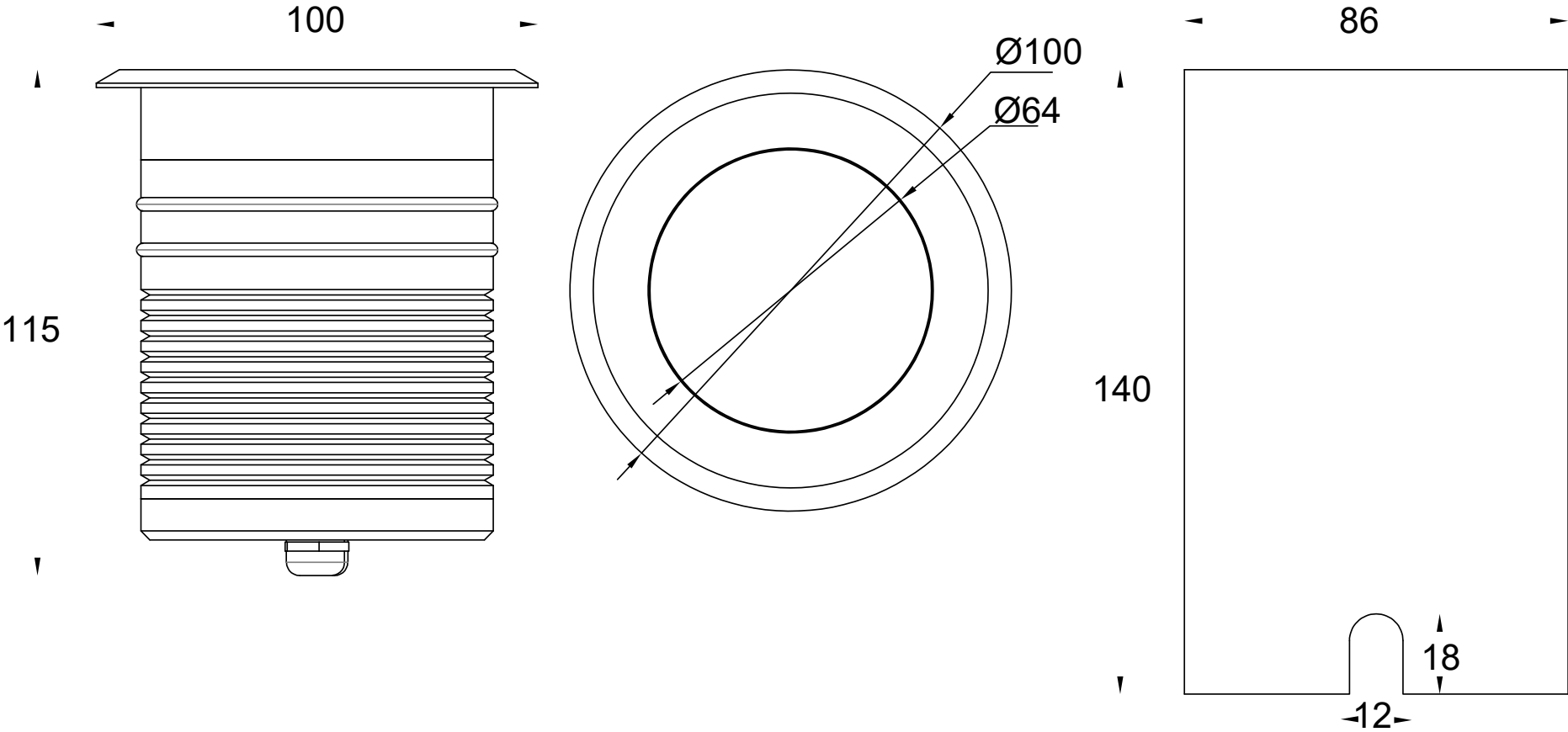

Unit: mm