

Instruction

CAUTIONS:

- This lighting fitting is class 1 and must be connected to an Earth circuit.
- Please read this instruction carefully before commencing any work..
- This unit must be fitted by a competent and qualified electrician.
To prevent electrocution switch off at mains supply before installing or maintaining this fitting.
Ensure other persons cannot restore the electrical supply without your knowledge

INSTALLATION:

1. Remove screws of frame, take out the frame and reflector
2. Install and fix fitting to the ceiling.
3. Connect power to the connector
4. Install reflector and tubes.
5. Re-install the screw of frame.

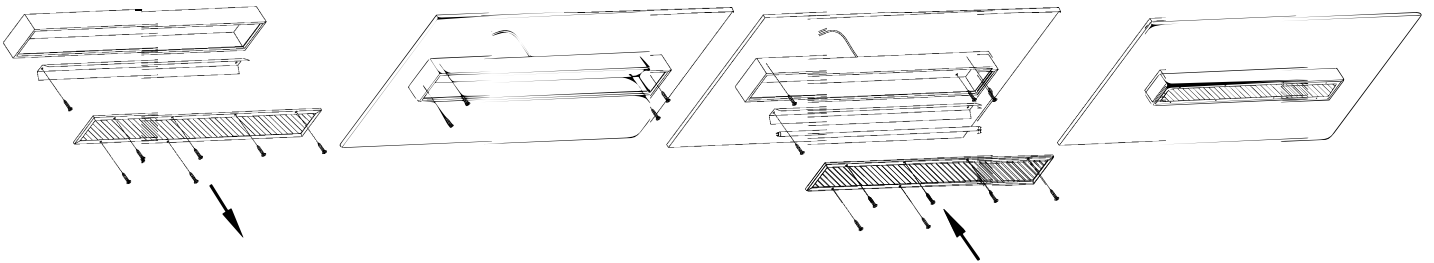

OR

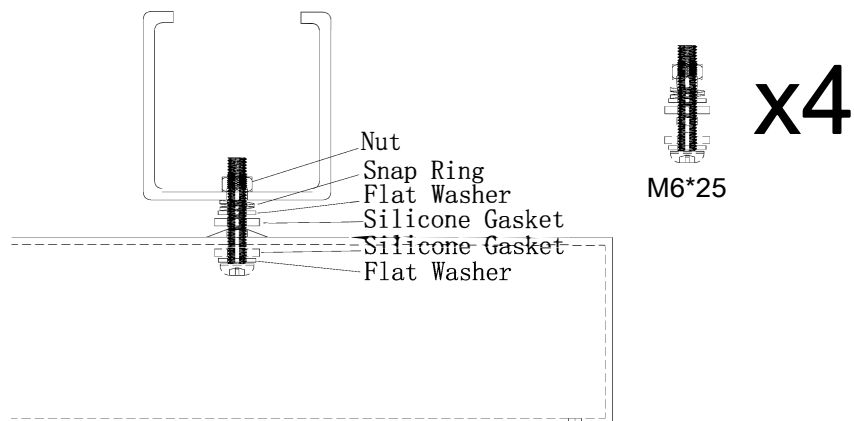
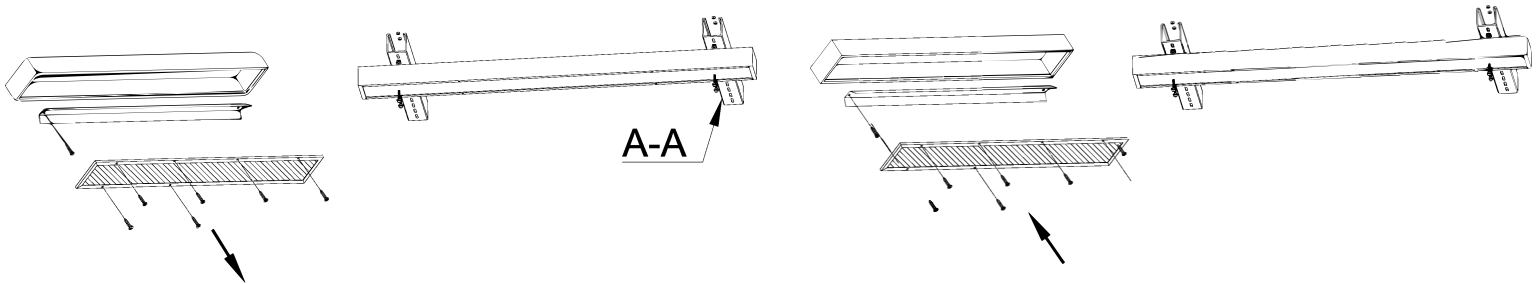

A-A