

Panel connection diagram

Reversing connection may cause lighting delay.

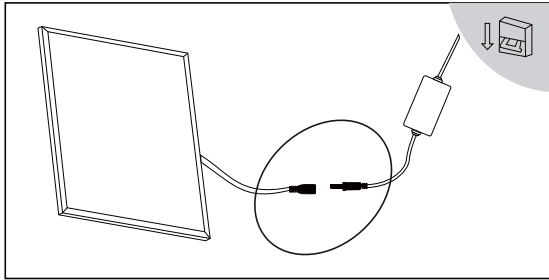

1.Connect driver to the panel

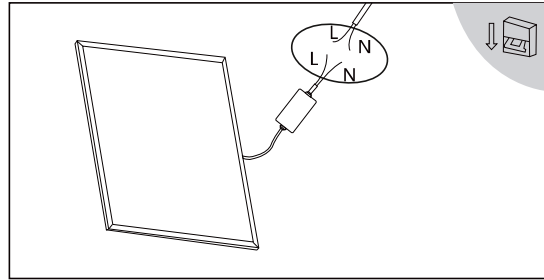

2.Then connect with city power(L-L;N-N)

Recession Installation

Customers can choose safety rope to avoid lamp falling caused by uncertain factors(earthquake,etc).

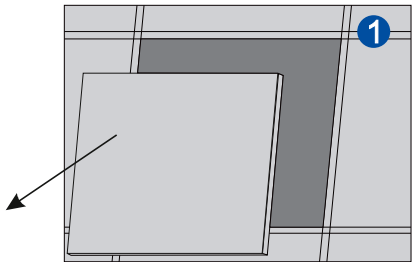

1.Remove the plasterboard from the ceiling.

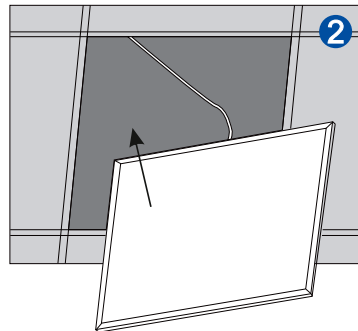

2.Fix the panel into ceiling.

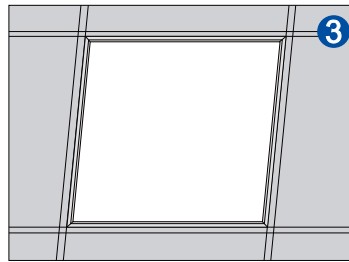

3.Installation finished.

DIMON
TECHNOLOGY

Installation Procedure

WARNING ⚡

- 1.Switch off before installation.
- 2.Switch on only after complete installation and examination of the circuit.
- 3.Professional electrician for installation and maintenance only.

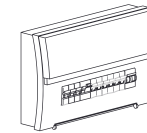

**Turn Off
Power Supply**

Turn Off power supply before starting any installation.
Read instructions & check you have all the tools & accessories
to complete the installation correctly.

Spring Installation

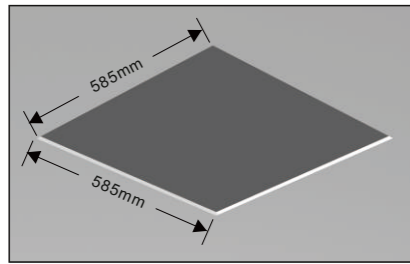

1. Open a hole on the ceiling with a size 585x585mm

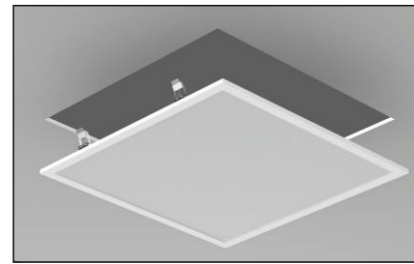

2. Pull up the springs

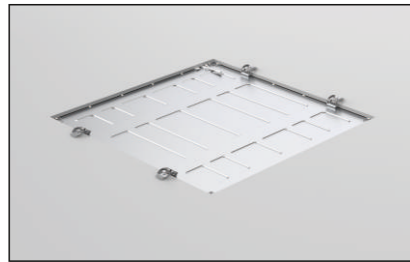

3. Install the panel to the hole

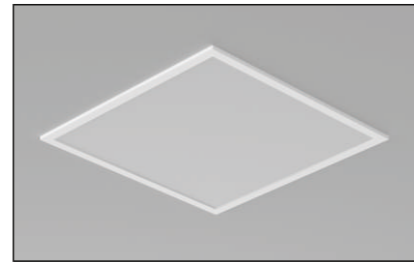

4. Fix the panel to the ceiling

Suspension Installation



■ Panel 600x600

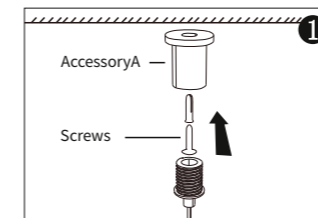

1. Screwing accessories A in ceiling

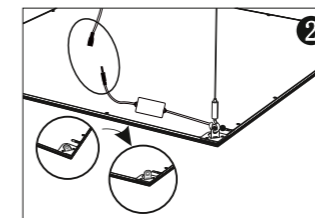

2. Upward hook on 4 corners, for suspending

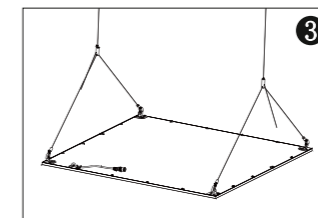

3. Finished installation

■ Panel 300x1200 600x1200

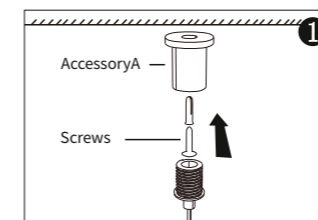

1. Screwing accessories A in ceiling

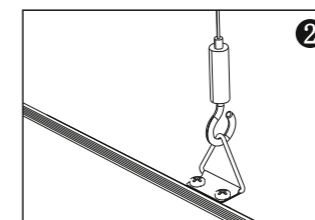

2. Triangle rings for hooks



3. Finished installation

Recessed Frame

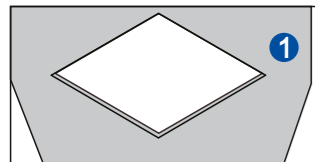

1. Open a hole on the ceiling.

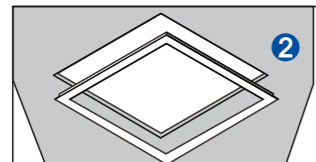

2. Fix the frame to the hole.

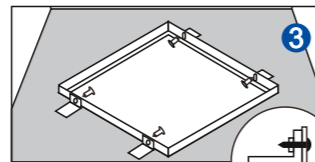

3. Fix the frame to the ceiling with the screws and "L" accessory.

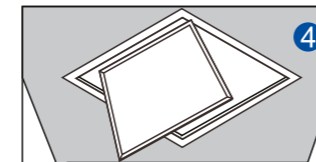

4. Put the panel into the frame.

Surface Mounted Frame

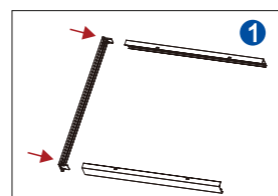

1. Assemble the 3 pieces of frame by metal bracket.

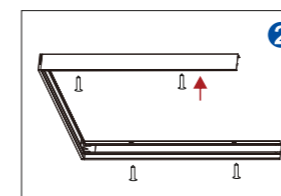

2. Fix the square frames in to ceiling with Screw.

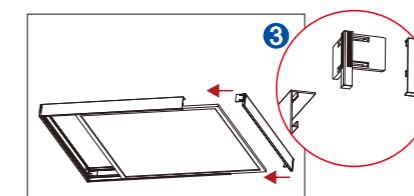

3. Insert the panel into frames and fix the cover plate frame.

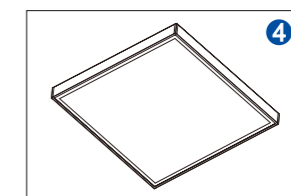

4. Finished frame installation.