

INGROUND LIGHT

Installation Manual

Thanks for using our product, our product is produced based on national standards. In order to install the lamp correctly, pls check carefully this installation manual. Installation or maintenance operations must be worked by professional electrician. Pls don't connect the power before installation or maintenance. The wrong installation and maintenance, or don't follow this manual, it will cause electrocuted.

1. Installation requirement

- 1) Prepare all accessory of lamp installation.
- 2) Pls be sure that lamp is cut off the power , during the installation or maintenance.
- 3) The using voltage can't exceed the rated voltage.
- 4) The power cable specification must be CCC certificated waterproof power cable.
- 5) Can't use the lamp in the corrosivity, inflammability and Explosive environment.
- 6) The installation method as below picture:

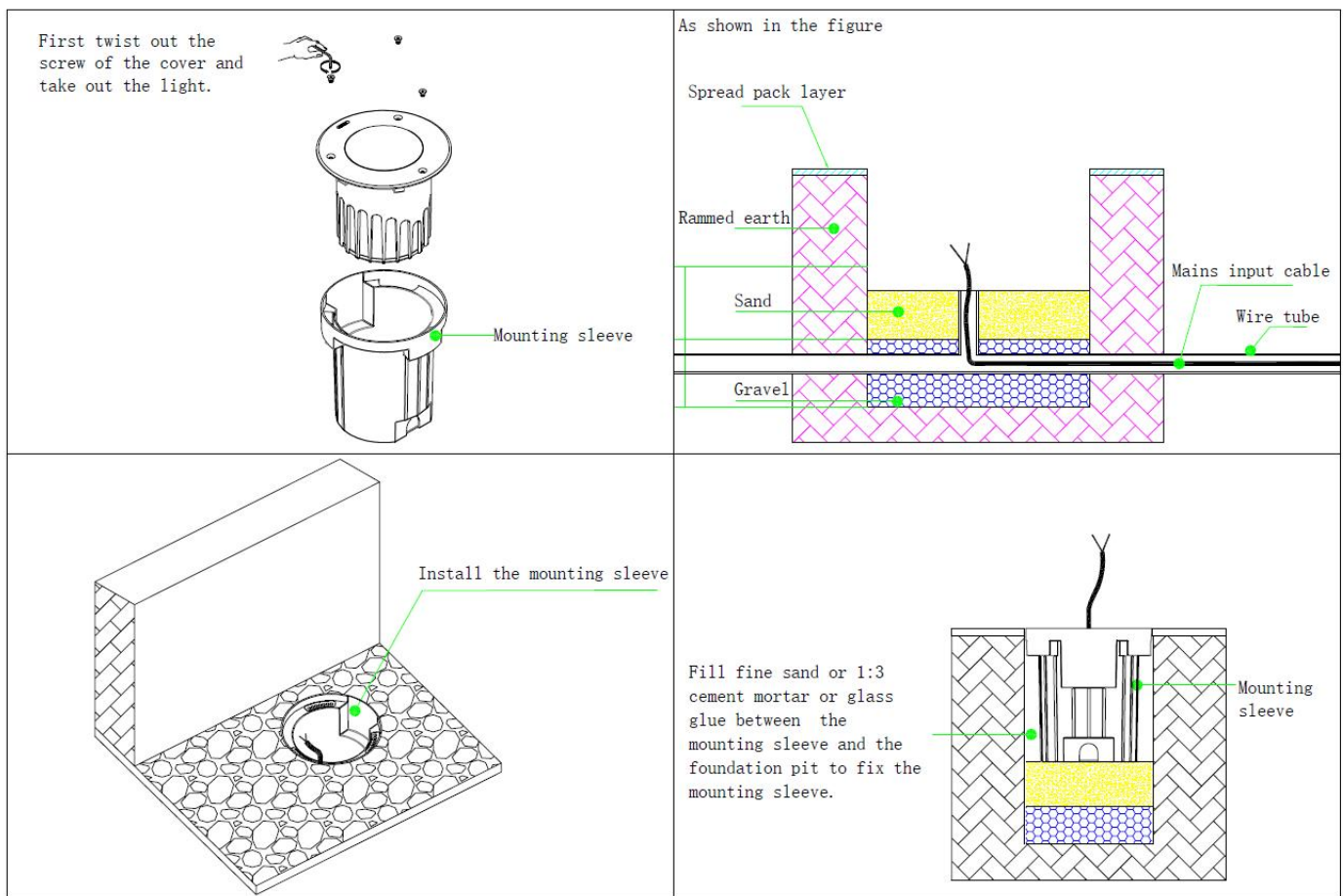

LACARY PRO -ADJUSTABLE

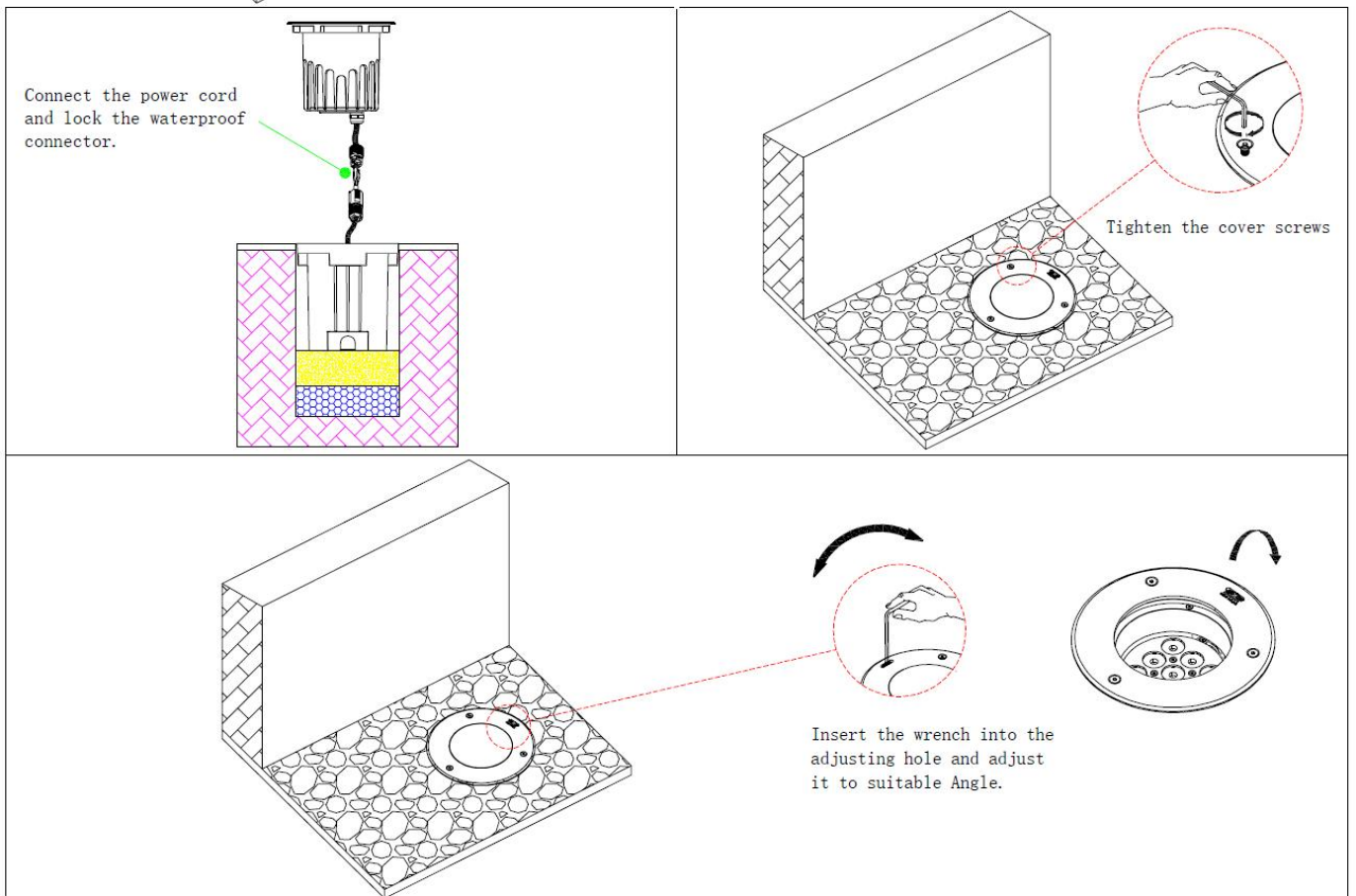

7) Pls be sure that the lamp input power cable connection with project site driver power cable is correct(DC24V+:brown, DC24V-:blue). If not, the water will go though the cable, then affect the lamp using.

2. Two different kinds of cable connection:

1) Male&female connector: as picture



Rotated the nut to location notch, and push back the nut, Adjust the male&female connect at the same level, so that it can lock mutual tightly, then push and tighten the female connector.

2) Waterproof junction box: as picture

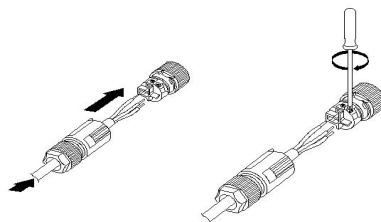

Connect the lamp power with driver power cable, and lock the waterproof connector

3. Pls double check the cable connection is correct, then turn on the lamp, and finish installation.
(24VDC lamp can't connect AC220 directly, it must connect 24VDC driver firstly)

4. Lamp connection diagram:

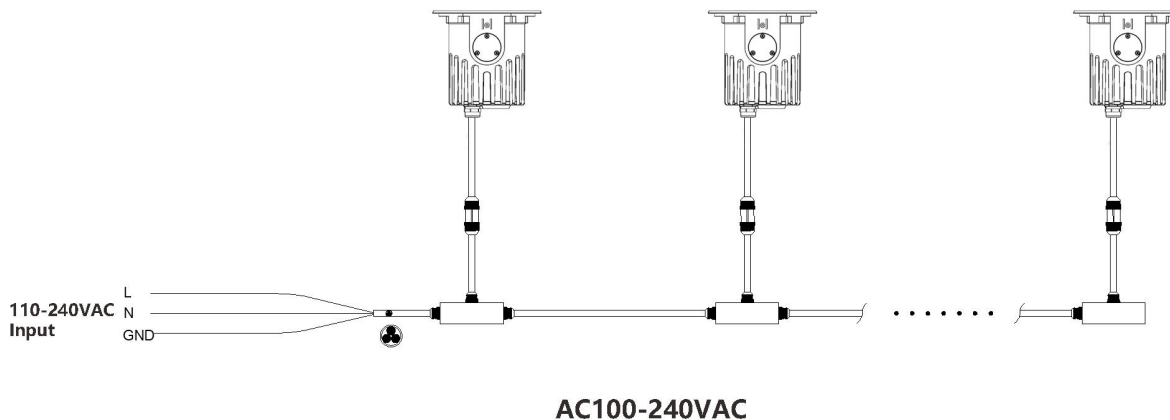

5. Note

In order to avoid the lamp breakage, fall, electric shock, fire and other accidents that threaten personal safety, please strictly follow the installation and use instructions, can't modify the lamp and change lamp inner electrical parts by yourself.

5.1 The power supply can't exceed the rated range (input voltage 24VDC) . Using lamp over the rated voltage for a long time, it will cause the lamp overheating and broken.

5.2 In order to avoid electric shock, pls take off the driver before install the lamp. The lamp must be turned on after complete the installation.

5.3 The lamp can't install at the heat source and corrosive gases place, so as not to affect the lamp life time.

5.4 Pls ensure that install area can bear 10 times of product weight, before you install the lamp. And install the lamp at no vibration/swing/fire place.

5.5 lamp external flexible cable or cable (cable requirements IP67) can not be replaced; if the flexible cable damage, the lamp should be scrapped.

5.6 The lamp external cable(require IP67) can't replaced.If the cable is damage, then the lamp is useless.

5.7 The light source of lamp need to be replaced by the manufacturer and its agent or similar qualified people.