







## LONON

### VANDAL RESISTANT LUMINAIRES FOR T5 LED TUBES

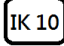
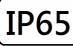

- Applications:  
Pedestrian Subways; Footbridge; Kiosk Canopy; Cover walkway ect
- 1 mm thick zinc coated steel body finished in chemical and abrasion resistant textured polyester powder coated
- Stainless steel security screws
- Pure aluminum reflector painted in fine textured white
- Easy installation for T5 LED tube

### Technical Data

Luminaire Type-安裝方式/Tipo de luminaria	Surface or Wall Mounted 表面或壁掛式 Montaje en superficie o en pared
Dimension-尺寸-Dimensión	L: 630 x W120 x H100mm L1230 x W120 x H100mm L1530 x W120 x H100mm
Input Voltage / 輸入電壓 Voltaje de entrada	220-240V/AC 50/60Hz
Power Consumption with LED Driver LED燈具包括LED驅動電源功率 Consumo de energía con controlador de LED	<p>Single Tube Batten LED T5</p> <p>2feet : 7W - 1 pcs x 7W LED T5      8W - 1 pcs x 8W LED T5 2feet : 9W - 1 pcs x 9W LED T5      10W - 1 pcs x 10W LED T5 4feet : 12W - 1 pcs x 12W LED T5     14W - 1 pcs x 14W LED T5 4feet : 16W - 1 pcs x 16W LED T5     18W - 1 pcs x 18W LED T5 4feet : 20W - 1 pcs x 24W LED T5 5feet : 22W - 1 pcs x 22W LED T5     25W - 1 pcs x 25W LED T5 5feet : 28W - 1 pcs x 28W LED T5     32W - 1 pcs x 32W LED T5</p> <p>Twin Tube Batten LED T5</p> <p>2feet : 14W - 2 pcs x 7W LED T5      16W - 2 pcs x 8W LED T5 2feet : 18W - 2 pcs x 9W LED T5      20W - 2 pcs x 10W LED T5 4feet : 24W - 2 pcs x 12W LED T5     28W - 2 pcs x 14W LED T5 4feet : 32W - 2 pcs x 16W LED T5     36W - 2 pcs x 18W LED T5 4feet : 48W - 2 pcs x 24W LED T5 5feet : 44W - 2 pcs x 22W LED T5     50W - 2 pcs x 25W LED T5 5feet : 54W - 2 pcs x 28W LED T5     64W - 2 pcs x 32W LED T5</p>
LED Driver Type LED驅動款式 Tipo de controlador LED	<p>Integrate-type LED Driver--Constant Current LED Driver</p> <p>Refer to LED driver specification 請參閱LED驅動器規格 Consulte la especificación de controlador de LED</p> <p>1. ON/OFF Switch AC220-240V 50/60HZ 2. 0-10V Dimming Step (50%, 75%, 85% and 100%) for DC LED T5 3. Dali Dimming Driver AC220-240V 50/60HZ or DC LED T5 4. Microwave sensor / PIR Sensor / Daylight Sensor 5. Emergency Backup &gt;2 hours or &gt;3 hours @ &lt; 12 charger hours 應急電池/Copia de seguridad de emergencia</p>
LED Driver Features Constant Current LED Driver: 驅動特性-恆流LED驅動器 Funciones del controlador de LED	<p>POWER FACTOR : PF&gt;0.95 TOTAL HARMONIC DISTORTION: THD&lt;15%</p>
Control Protocol/控制協議/Protocolo de Control	1-10V/ PIR/ Microwave sensor/ DALI
"Lumen Maintenance LM-80 Reported by TM-21"	L70 > 60,000 hrs
LED Life-LED壽命-La vida del LED	>100,000 hours
Color Temperature -色溫 Temperatura del color	3000K / 4000K / 5000K / 6500K
Color Rendering Index-顯色指數 Índice de reproducción cromática	>80
MacAdam Ellipses Binning 麥克亞當橢圓分級 Mac Adam binning elipse	Standard Deviation Colour Matching < 3 SDCM 標準偏差配色< 3 SDCM Coincidencia de color estándar Desviación < 3 SDCM
Beam Angle光束角/ángulo de haz	120°
Luminaire Efficacy燈具效率 La eficacia de la luminaria	<p>Clear diffuser: 110 Lm/w(3000K)    110 Lm/w(4000K)    120 Lm/w(5000K)    120 Lm/w(6500K)</p> <p>Milky diffuser: 90 Lm/w(3000K)    100 Lm/w(4000K)    110 Lm/w(5000K)    110 Lm/w(6500K)</p>
LED T5 Tube Luminous Efficacy LED T5 Tube光效 Eficacia del tubo LED T5	<p>180 Lm/w (3000K)    190 Lm/w (4000K)    200 Lm/w (5000K)    200 Lm/w (6500K)</p> <p>Basing on TUTA- LED T5 Master Version</p>
Housing materials-外殼材料 Materiales de la carcasa	<p>1 mm Zinc coated steel body and Milky or Clear Polycarbonate</p> <p>1 mm 鍍鋅鋼板和乳白或透明聚碳酸酯片</p> <p>Cuerpo de acero galvanizado de 1 mm o acero inoxidable y policarbonato lechoso o transparente</p>
Housing Color外殼顏色 color de la carcasa	Matte White 啞白色 Blanco mate
Ingress Protection-防護等級 Protección de ingreso	IP65
Mech impact protection 機械衝擊保護 Protección contra impactos mecánicos	IK 10
Operating Humidity -工作濕度 Humedad de funcionamiento	0~100%, non-condensing-不結霜 sin condensación
Operating Temperature Range / 工作溫度範圍 Rango de temperatura de funcion amento	-30 °C / +50 °C
Comply Testing Standard 符合測試標準 Cumplir el estándar de prueba	<p>LED Luminaries: LVD: IEC/EN 60598-1;EN / IEC/EN 60598-2-1;IEC62471;IEC/EN 62031; IEC/EN 62493 ; IEC/EN 62471 TM21</p> <p>LED Driver: IEC/EN 61347-1; IEC/EN 61347-2-13; IEC/EN 62384; IEC/EN 61000-3-2 IEC/EN 61000-3-3;IEC/EN61574; EN 55015 ; IEC /EN 62384</p>
Certification-認證-Certificación	        

Project	Fixture#	Date
		Firm

## Ordering Information

Choose the option that suits your need and write its corresponding code on the appropriate line to form the product code.

Example product code: [LONON-16W](#)

LONON - -

POWER  
CONSUMPTION

POWER CONSUMPTION	
Code	Description
7W	1x 7W 2ft LED T5 @ L630 x120 x100mm
8W	1x 8W 2ft LED T5 @ L630 x120 x100mm
9W	1x 9W 2ft LED T5 @ L630 x120 x100mm
1X10W	1x 10W 2ft LED T5 @ L630 x120 x100mm
12W	1x 12W 4ft LED T5 @ L1230 x120 x100mm
14W	1x 14W 4ft LED T5 @ L1230 x120 x100mm
16W	1x 16W 4ft LED T5 @ L1230 x120 x100mm
18W	1x 18W 4ft LED T5 @ L1230 x120 x100mm
20W	1x 20W 4ft LED T5 @ L1230 x120 x100mm
22W	1x 22W 5ft LED T5 @ L1530 x120 x100mm
25W	1x 25W 5ft LED T5 @ L1530 x120 x100mm
28W	1x 28W 5ft LED T5 @ L1530 x120 x100mm
32W	1x 32W 5ft LED T5 @ L1530 x120 x100mm
14W	2x 7W 2ft LED T5 @ L630 x120 x100mm
16W	2x 8W 2ft LED T5 @ L630 x120 x100mm
18W	2x 9W 2ft LED T5 @ L630 x120 x100mm
20W	2x 10W 2ft LED T5 @ L630 x120 x100mm
24W	2x 12W 4ft LED T5 @ L1230 x120 x100mm
28W	2x 14W 4ft LED T5 @ L1230 x120 x100mm
32W	2x 16W 4ft LED T5 @ L1230 x120 x100mm
36W	2x 18W 4ft LED T5 @ L1230 x120 x100mm
40W	2x 20W 4ft LED T5 @ L1230 x120 x100mm
44W	2x 22W 5ft LED T5 @ L1230 x120 x100mm
50W	2x 25W 5ft LED T5 @ L1230 x120 x100mm
56W	2x 28W 5ft LED T5 @ L1230 x120 x100mm
64W	2x 32W 5ft LED T5 @ L1230 x120 x100mm

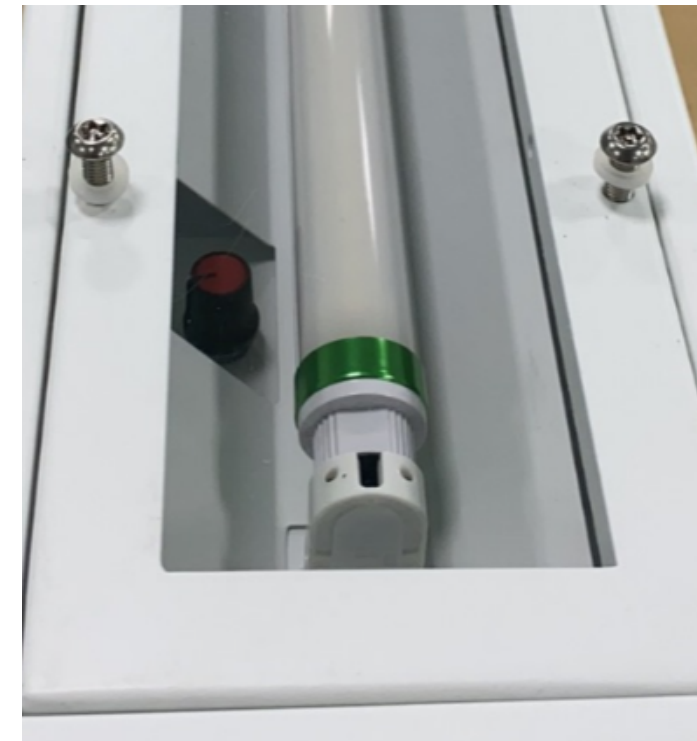

Integrated 0-10V or Dali Dimmable  
LED Driver & Selector Switch for  
Dimming Output:  
Rotary (0/1-10V) Dimming (50%,  
75%, 85% and 100%)

# BEAM ANGLE

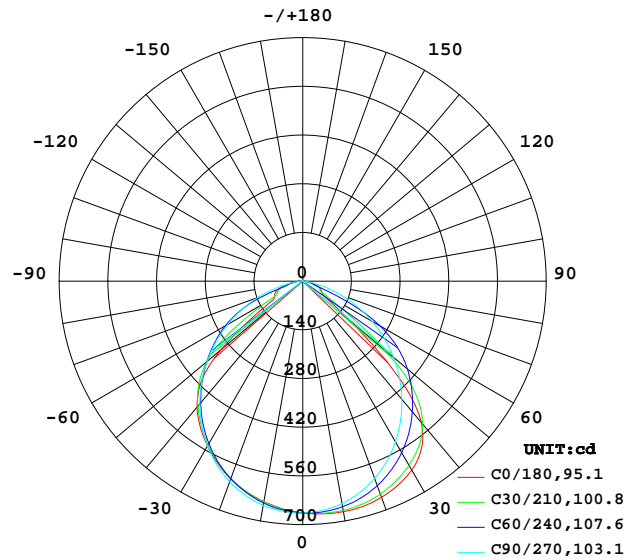

**Clear Polycarbonate**

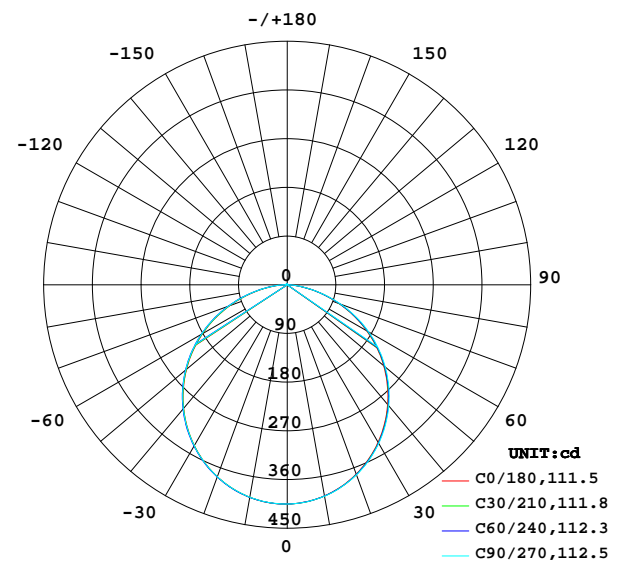

**Opal Polycarbonate**

# Technical Drawing

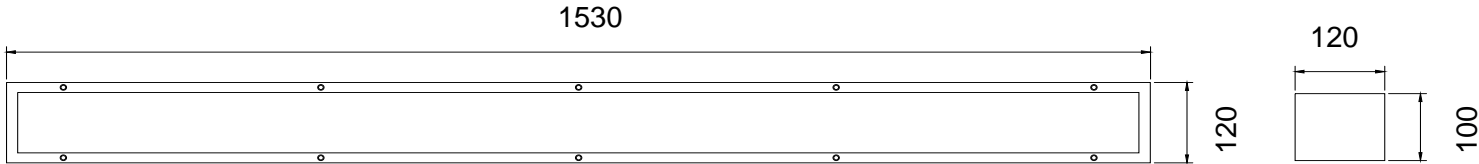
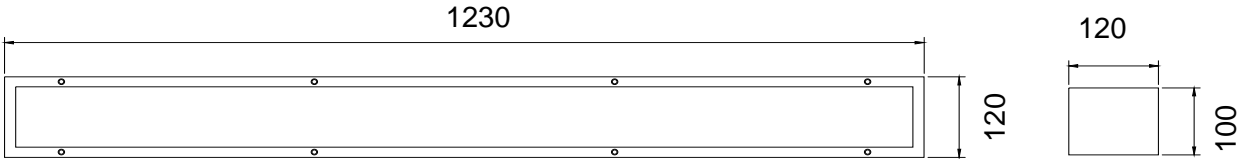
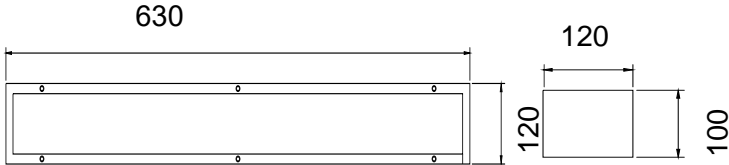

Unit: mm

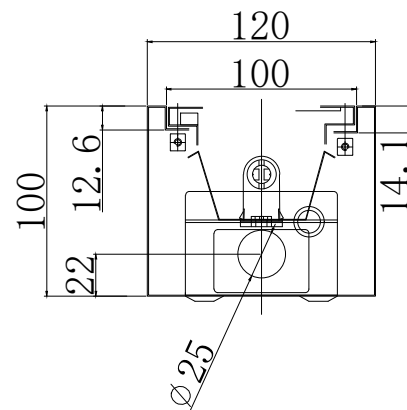
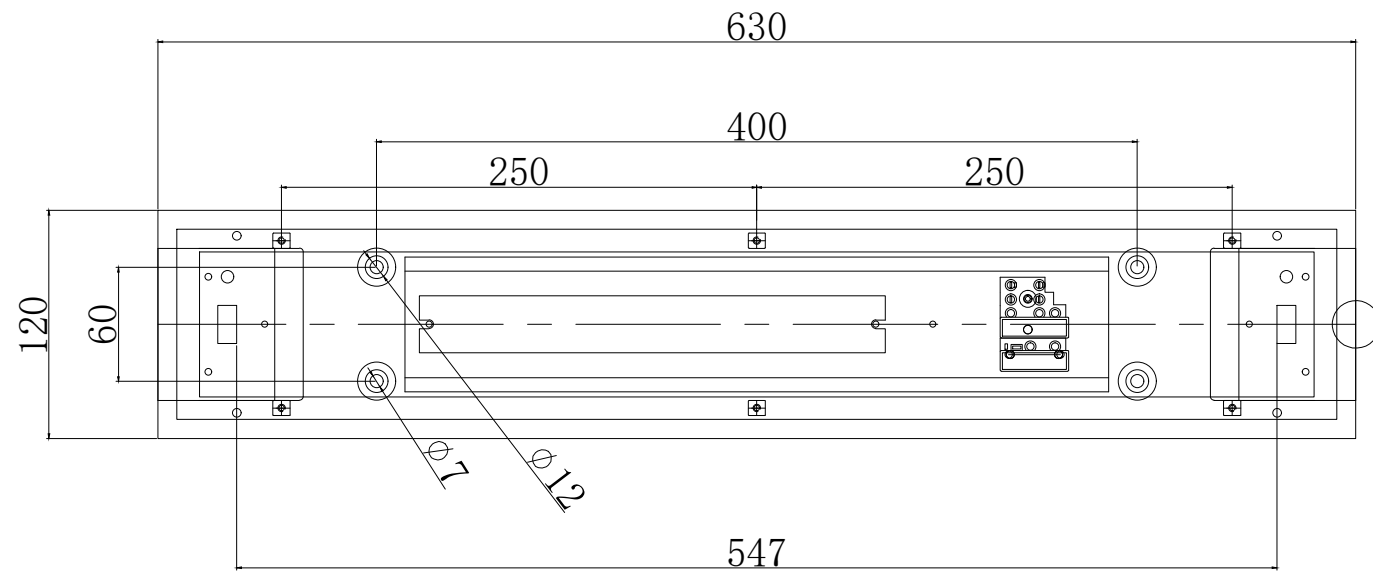
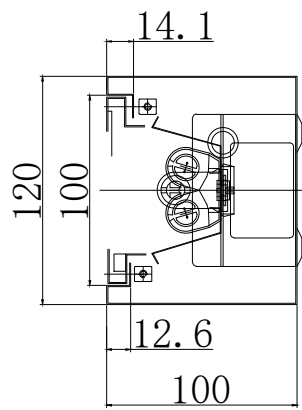
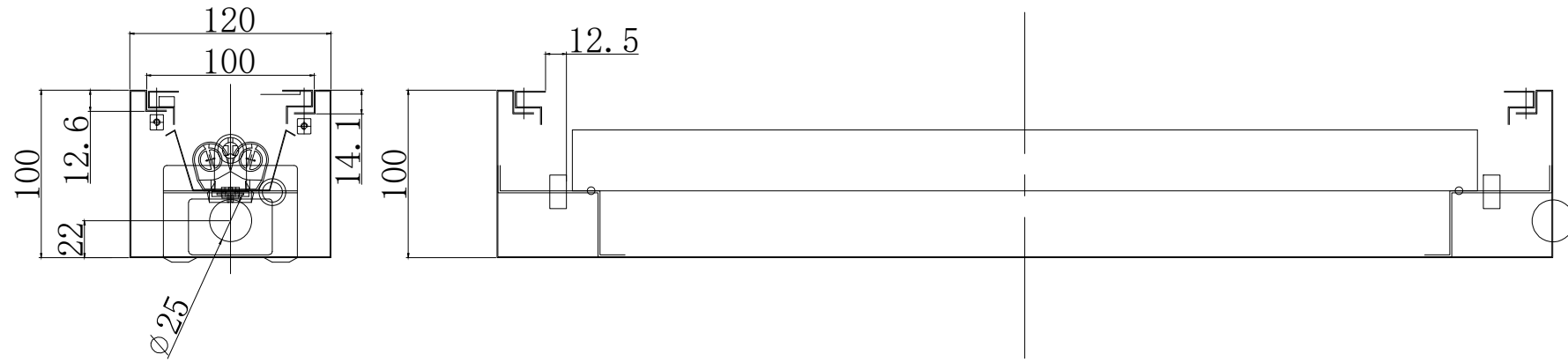

Single

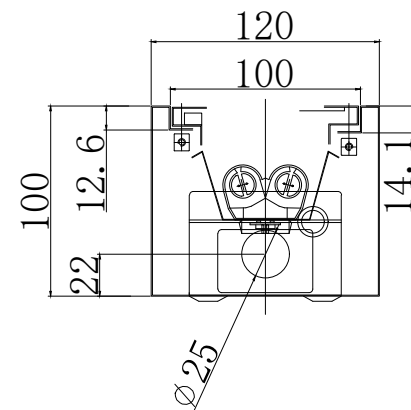

Twin

**DIMON**  
Technology

DIMON Technology Ltd.

Tel: 00852-3916 5876  
Fax: 00852-21203398  
Http://www.dimontechnology.com  
E-mail: gary@dimontechnology.com

**Job Title:**

**Drawing Name:**

LONON-01

Drawing NO. : TD-240731-001

Drawing Scale: AS SHOW

Drawing Date: 2024/07/30

Drawing: Joyi

Collate: Alove

Auditing: Denny

Drawing Version: V2

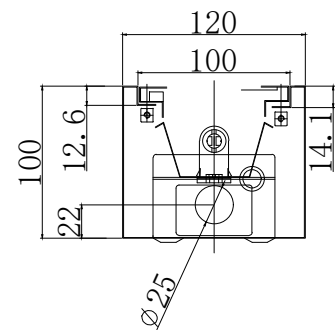
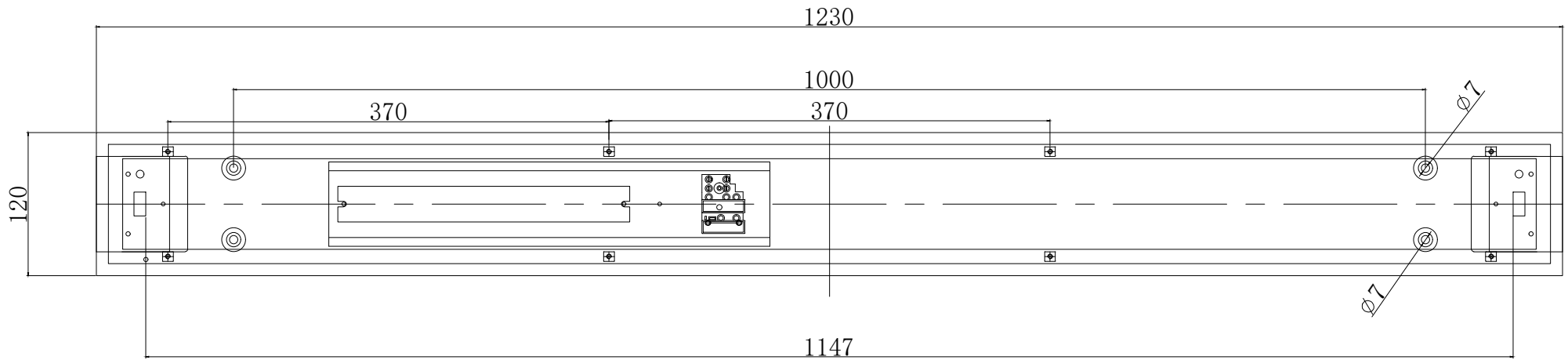
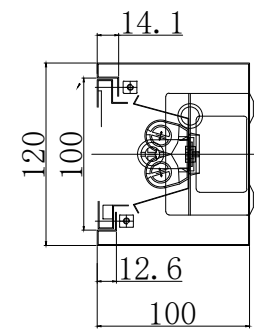
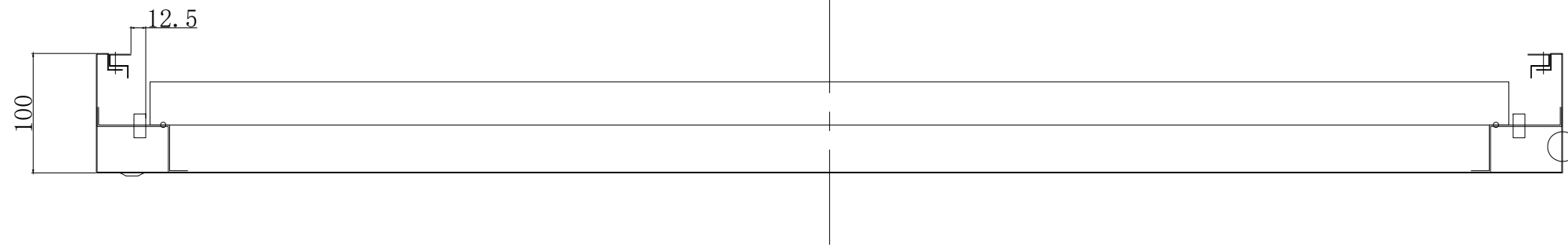
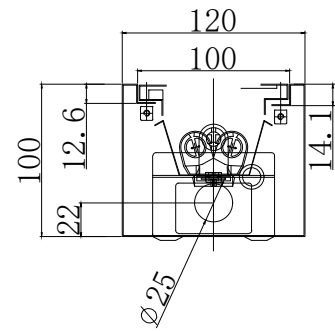

Single

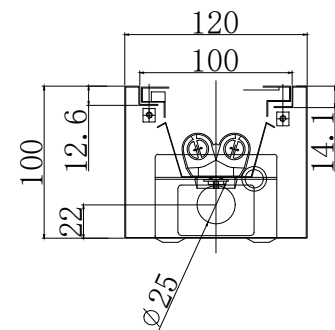

Twin

# DIMON

Technology

DIMON Technology Ltd.  
 Tel: 00852-3916 5876  
 Fax: 00852-21203398  
 Http://www.dimontechnology.com  
 E-mail: gary@dimontechnology.com

**Job Title:**

**Drawing Name:**

LONON-02

Drawing NO.: TD-240731-002

Drawing Scale: AS SHOW

Drawing Date: 2024/07/30

Drawing: Joyi

Collate: Alove

Auditing: Denny

Drawing Version: V2

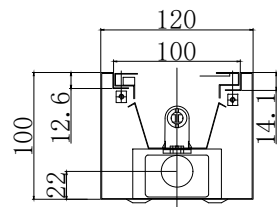
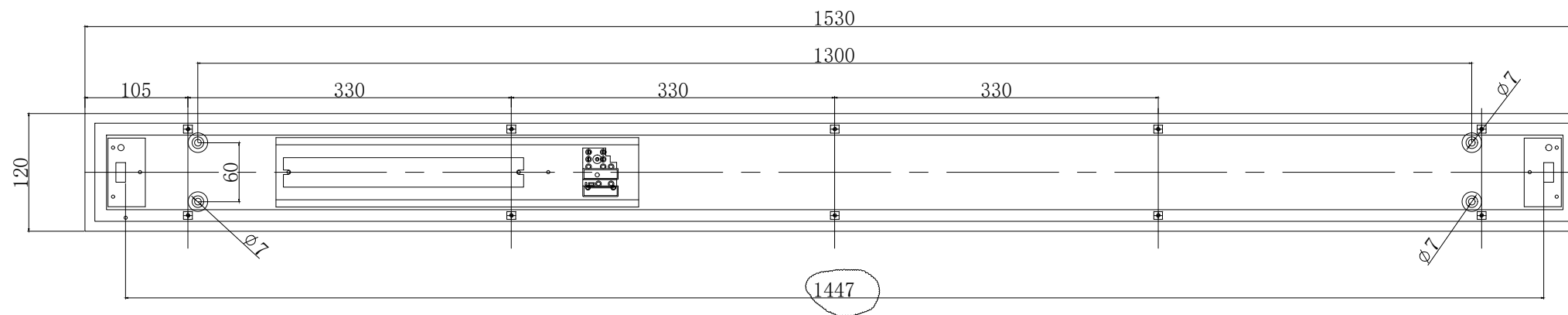
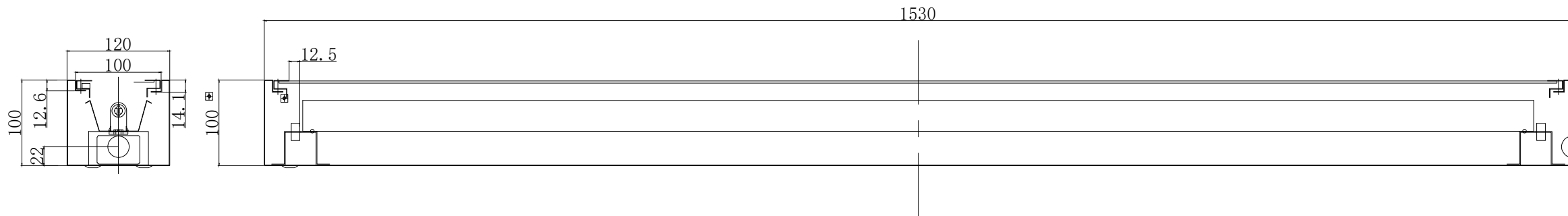

Single

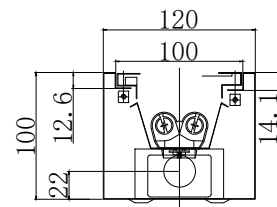

Twin

**DIMON**  
Technology

DIMON Technology Ltd.

Tel: 00852-3916 5876  
 Fax: 00852-21203398  
 Http://www.dimontechnology.com  
 E-mail: gary@dimontechnology.com

**Job Title:**

**Drawing Name:**

LONON-03

Drawing NO.: TD-240731-003

Drawing Scale: AS SHOW

Drawing Date: 2024/07/30

Drawing: Joyi

Collate: Alove

Auditing: Denny

Drawing Version: V2



Use 1 set LED T5 16W

**DIMON**  
TECHNOLOGY

Technical Datasheet

**TUTA**

LED T5 Tube 30W Max



LED T5 Tube is a cost-effective LED replacement for T5 fluorescent tubes and made by aluminum shell with PC cover. The luminaire is compatible with existing T5 installations in look and feel with far superior lighting performance. With its extremely long lifetime 50,000 hours.

## Technical Data

Cap base 燈腳 Base de la tapa	G5
Dimension-尺寸-Dimensión	<ul style="list-style-type: none"> <li>• 2 feet 548mm (562mm)    3 feet 848mm (862mm)</li> <li>• 4 feet 1148mm (1162mm)    5 feet 1448mm (1462mm)</li> </ul>
Input Voltage-輸入電壓-Voltaje de entrada	<ul style="list-style-type: none"> <li>• AC100-240V 50/60Hz / DC220-240V</li> <li>• DC Input for Remoted LED Dimming Driver 1-10V / Dali / Zigbee Wireless Dimming Control</li> </ul>
Power Consumption 燈具功率 Consumo de energía Max	<ul style="list-style-type: none"> <li>• 6W @ 2 feet    8W @ 2 feet    9W @ 2 feet    10W @ 2 feet</li> <li>• 11W @ 3 feet    13W @ 3 feet</li> <li>• 14W @ 4 feet    16W @ 4 feet    18W @ 4 feet    20W @ 4 feet</li> <li>• 22W @ 5 feet    26W @ 5 feet    30W @ 5 feet</li> </ul>
Power factor 功率因數 Factor de potencia	PF > 0.95
TOTAL HARMONIC DISTORTION 總諧波失真 DISTORSIÓN ARMÓNICA TOTAL	THD < 18%
Beam Angle 光束角 ángulo de haz	140°
Light Source Brand-光源品牌-Fuente de luz de marca	Everlight SMD
Photobiological safety-IEC 62471 / of Luminaire 光生物安全檢驗(ICE/EN 62471) 結果: Seguridad fotobiológica-IEC 62471	<ul style="list-style-type: none"> <li>Low Risk Group 1 (RG 1)</li> <li>低風險組1 (RG 1)</li> <li>Grupo de bajo riesgo 1 (RG 1)</li> </ul>
LED Life-LED壽命-La vida del LED	>50,000 hours
Lumen Maintenance TM-21 L70 @ 25 °C 流明維持率(光通量衰減) 報告: TM-21 L70 @ 25 °C Mantenimiento de lúmenes ITM-21 L70 @ 25 °C	L70 > 54,000hours
Color Temperature -色溫 Temperatura del color	• 2700k    3000K    4000K    5000K    6500K
Color Rendering Index-顯色指數 Índice de reproducción cromática	> 80
MacAdam Ellipses Binning 麥克亞當橢圓分級 Mac Adam binning ellipse	<ul style="list-style-type: none"> <li>Standard Deviation Colour Matching &lt; 3 SDCM</li> <li>標準偏差配色 &lt; 3 SDCM</li> <li>Coincidencia de color estándar Desviación &lt; 3 SDCM</li> </ul>
Luminaire Efficacy 燈具效率 La eficacia de la luminaria	<p><b>Standard Series</b></p> <ul style="list-style-type: none"> <li>• 110 Lm/w@ 2700K    120 Lm/w@ 3000K    130 Lm/w@ 4000K</li> <li>• 130 Lm/w@ 5000K    130 Lm/w@ 6500K</li> </ul> <p><b>Advance Series</b></p> <ul style="list-style-type: none"> <li>• 140 Lm/w@ 2700K    140 Lm/w@ 3000K    150 Lm/w@ 4000K</li> <li>• 160 Lm/w@ 5000K    160 Lm/w@ 6500K</li> </ul> <p><b>High Efficiency Series</b></p> <ul style="list-style-type: none"> <li>• 170 Lm/w@ 2700K    170 Lm/w@ 3000K    190 Lm/w@ 4000K</li> <li>• 200 Lm/w@ 5000K    200 Lm/w@ 6500K</li> </ul>
Housing materials-外殼材料 Materiales de la carcasa	6063 Aluminum shell and PC cover    6063鋁殼和PC罩 Cáscara de aluminio 6063 con cubierta de policarbonato.
Housing Color外殼顏色color de la carcasa	Milky Diffuser 乳白色罩 Milky difusor
Weight 重量 Peso	• 175g @2feet    221g @3feet    276g @4feet    357g @5feet
Ingress Protection-防護等級 Protección de ingreso	IP40
Operating Temperature Range / 工作溫度範圍 Rango de temperatura de funcionamiento	Rango de temperatura de funcionamiento -30 °C / +50 °C
Operating Humidity -工作濕度 Humedad de funcionamiento	0~90%, non-condensing-不結霜 sin condensación
Comply Testing Standard 符合測試標準 Cumplir el estándar de prueba	EN/IEC 60598-1 ; EN/IEC60598-2-1 ; EN / IEC 60598-2-2 TR62778 EN/IEC 62031; EN60838-2-2 ; EN 62493;EN/IEC 61347-1; EN/IEC 61347-2-13; IEC 62384 EMC EN55005;EN 61000-3-2;EN 61000-3-3; EN 61547; IEC62384 ; IEC 62560:2011;IEC 62612; IEC 62766-1; IEC 62766-2-1 ROHS ; TM21

Certification-認證-Certificación



Project	Fixture#	Date
		Firm

## Ordering Information

Choose the option that suits your need and write its corresponding code on the appropriate line to form the product code.

Example product code: [TUTA-13W](#)

TUTA - - \_\_\_\_\_  
Power Consumption

Power Consumption	
Code	Description
6W	6W @ 2 feet
8W	8W @ 2 feet
9W	9W @ 2 feet
10W	10W @ 2 feet
11W	11W @ 3 feet
13W	13W @ 3 feet
14W	14W @ 4 feet
16W	16W @ 4feet
18W	18W @ 4 feet
20W	20W @4 feet
22W	22W @ 5 feet
26W	26W @ 5 feet
30W	30W @ 5 feet



# Technical Drawing

	2feet	3feet	4feet	5feet
	548 Dimension	848 Dimension	1148 Dimension	1448 Dimension
A:	562	862	1162	1462
B:	548	848	1148	1448

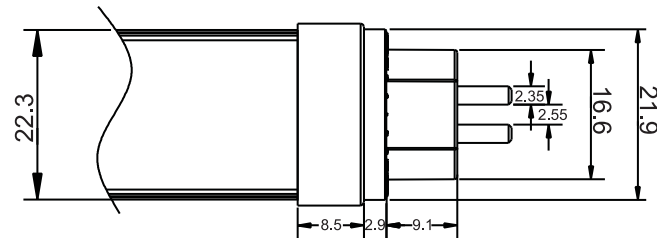
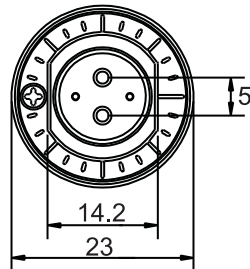
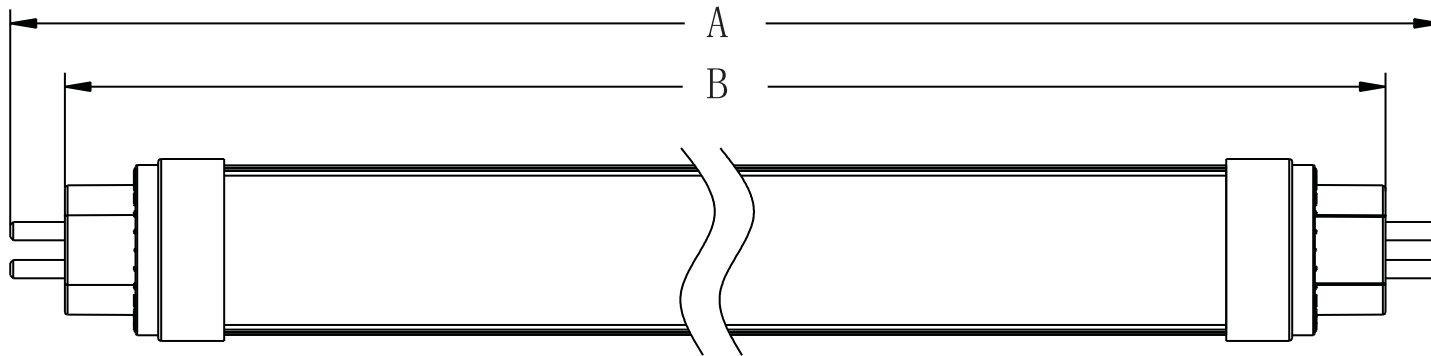

Unit: mm

# BEAM ANGLE

