

PONEE-G2

26-72W Max

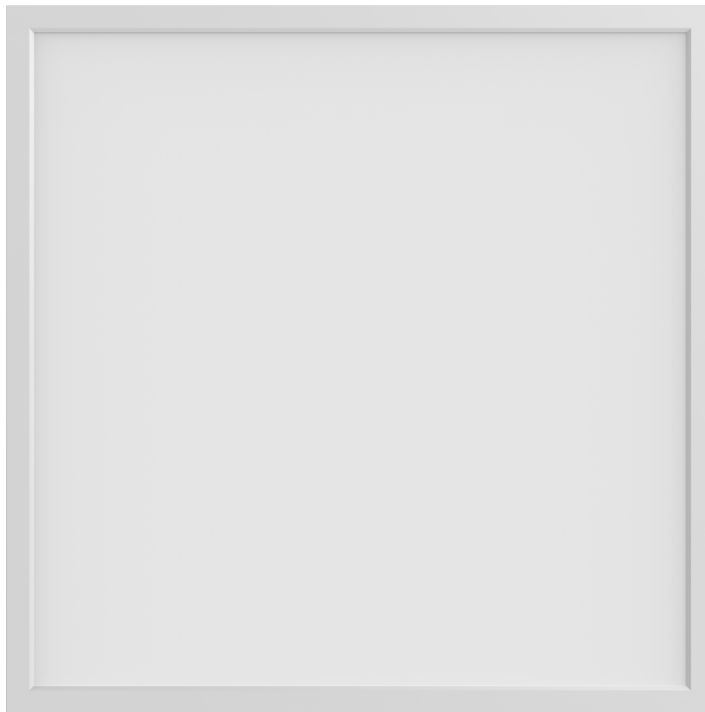

- UGR < 19 Anti-glare design,
- High lumen efficiency, 140lm/w.
- Installation ways: Suspended/surface mounted/Recessed.
- External Flicker free driver.
- Dimming ways: 0-10V,Dali.

Technical Data

Luminaire Type-安裝方式/Tipo de luminaria

Suspended/surface mounted/Recessed 懸掛式/表面安裝式/嵌入式

Dimension-尺寸-Dimensión	Refer to drawing 參考圖紙
Power Consumption Max-燈具功率 Consumo de energía Max	<ul style="list-style-type: none"> • W: 595* L: 595* H11mm :26W 30W 34W 36W 40W • W: 620* L: 620* H11mm :26W 30W 34W 36W 40W • W: 295* L: 1195* H11mm :26W 30W 34W 36W 40W • W: 595* L: 1195* H11mm :45W 50W 60W 72W
Input Voltage-輸入電壓-Voltaje de entrada	AC220-240V 50/60HZ
LED Driver Type/LED驅動款式 Tipo de controlador de LED	<p>Remoted-type LED Driver--Constant Current LED Driver: Refer to LED driver specification 請參閱LED驅動器規格 Consulte la especificación de controlador de LED</p> <ol style="list-style-type: none"> 1. ON/OFF Switch AC100-240V 50/60HZ 2. 0 -10V Dimming Driver AC100-240V 50/60HZ 3. Dali Dimming Driver AC100-240V 50/60HZ 4. Emergency Backup >2 hours or >3 hours @ < 12 charger hours 應急電池/Copia de seguridad de emergencia
LED Driver Features/驅動特性 Funciones del controlador de LED	POWER FACTOR : PF>0.90 @ Full Load TOTAL HARMONIC DISTORTION: THD< 20%
Control Protocol-控制協議 Protocolo de Control	0-10V / Dali / DMX 512
Beam Angle/光束角 ángulo de haz	90° 110°
Light Source Brand-光源品牌-Fuente de luz de marca	SMD LED
"Lumen Maintenance LM-80 Reported by TM-21"	L70 > 60000hours
LED Life-LED壽命-La vida del LED	>60,000 hours
Color Temperature -色溫 Temperatura del color	2700K / 3000K / 4000K / 5000K / 6500K
Color Rendering Index-顯色指數 Índice de reproducción cromática	> 80 >90
MacAdam Ellipses Binning 麥克亞當橢圓分級 Mac Adam binning elipse	Standard Deviation Colour Matching < 3 SDCM 標準偏差配色< 3 SDCM Coincidencia de color estándar Desviación < 3 SDCM
Luminaire Efficacy/燈具效率 La eficacia de la luminaria	110Lm/w(2700K), 110Lm/w(3000K), 125 Lm/w(4000K), 130 Lm/w(5000K), 130 Lm/w(6500K)
LED Source Luminous Efficacy/LED光源光效 Fuente luminosa LED Eficacia	150Lm/w(2700K), 150Lm/w(3000K), 175 Lm/w(4000K), 190 Lm/w(5000K), 190 Lm/w(6500K)
Housing materials-外殼材料 Materiales de la carcasa	Aluminium Alloy and Polycarbonate Reflector 鋁合金和PC反光杯 Aleación de aluminio y difusor de policarbonato
Housing Color/外殼顏色 color de la carcasa	White 白色 RAL9016
Ingress Protection-防護等級 Protección de ingreso	IP40
Operating Temperature Range / 工作溫度範圍 Rango de temperatura de funcionamiento	0~90%, non-condensing-不結霜 sin condensación
Operating Temperature Range / 工作溫度範圍 Rango de temperatura de funcionamiento	-30 °C / +50 °C
Comply Testing Standard 符合測試標準 Cumplir el estándar de prueba	<p>LED Luminaries: LVD: IEC/EN 60598-1;EN / IEC/EN 60598-2-1;IEC62471;IEC/EN 62031; IEC/EN 62493 ; IEC/EN 62471 (Risk Group 1)</p> <p>LED Driver: IEC/EN 61347-1; IEC/EN 61347-2-13; IEC/EN 62384; IEC/EN 61000-3-2; IEC/EN 61000-3-3;IEC/EN61574;EN 55015 ; IEC /EN 62384</p>

Certification-認證-Certificación



Project	Fixture#	Date
		Firm



Ordering Information

Choose the option that suits your need and write its corresponding code on the appropriate line to form the product code.

Example product code: [PONEE-60W](#)

PONEE-G2 - -

[Power Consumption](#)

Power Consumption	
Code	Description
26W	26W @ W: 595* L: 595* H11mm or W: 620* L: 620* H11mm or W: 295* L: 1195* H11mm
30W	30W @ W: 595* L: 595* H11mm or W: 620* L: 620* H11mm or W: 295* L: 1195* H11mm
34W	34W @ W: 595* L: 595* H11mm or W: 620* L: 620* H11mm or W: 295* L: 1195* H11mm
36W	36W @ W: 595* L: 595* H11mm or W: 620* L: 620* H11mm or W: 295* L: 1195* H11mm
40W	40W @ W: 595* L: 595* H11mm or W: 620* L: 620* H11mm or W: 295* L: 1195* H11mm
45W	45W@W: 595* L: 1195* H11mm
50W	50W@W: 595* L: 1195* H11mm
60W	60W@W: 595* L: 1195* H11mm
72W	72W@W: 595* L: 1195* H11mm

Technical Drawing



Available Sizes

595x595mm

295x1195mm

595x1195mm

620x620mm

Unit: mm

Panel connection diagram

Reversing connection may cause lighting delay.

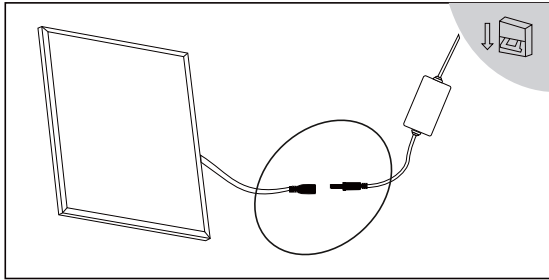

1.Connect driver to the panel

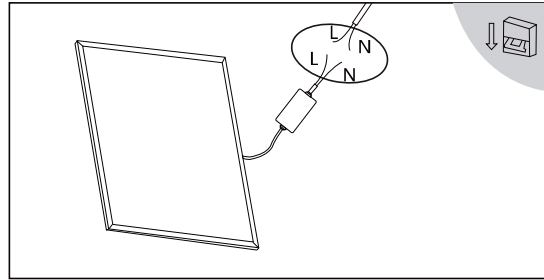

2.Then connect with city power(L-L;N-N)

Recession Installation

Customers can choose safety rope to avoid lamp falling caused by uncertain factors(earthquake,etc).

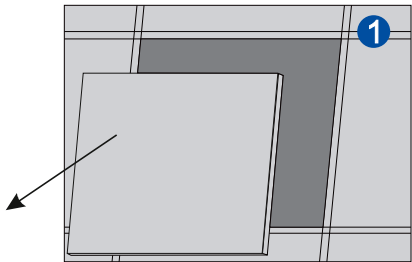

1.Remove the plasterboard from the ceiling.

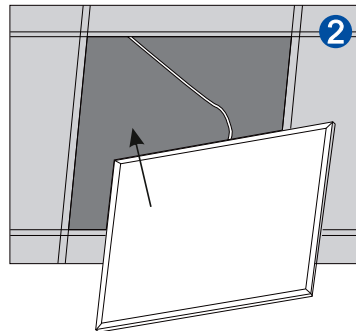

2.Fix the panel into ceiling.

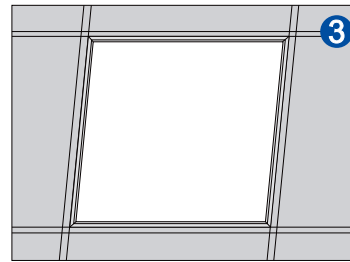

3.Installation finished.

DIMON
TECHNOLOGY

Installation Procedure

WARNING ⚡

- 1.Switch off before installation.
- 2.Switch on only after complete installation and examination of the circuit.
- 3.Professional electrician for installation and maintenance only.

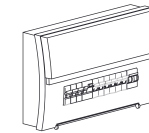

**Turn Off
Power Supply**

Turn Off power supply before starting any installation.
Read instructions & check you have all the tools & accessories
to complete the installation correctly.

Spring Installation

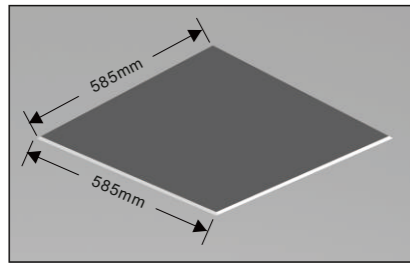

1. Open a hole on the ceiling with a size 585x585mm

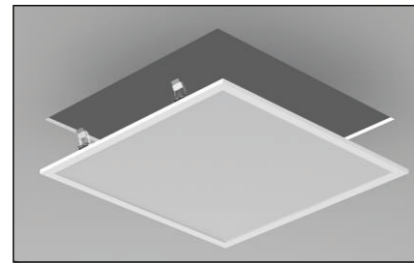

2. Pull up the springs

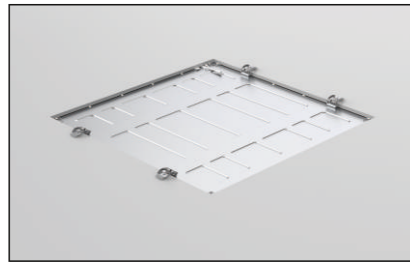

3. Install the panel to the hole

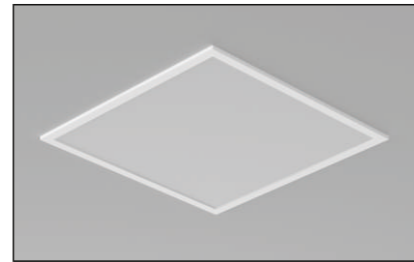

4. Fix the panel to the ceiling

Suspension Installation



■ Panel 600x600

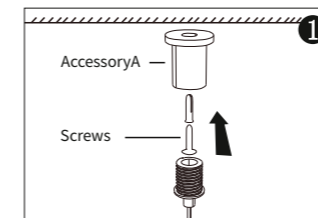

1. Screwing accessories A in ceiling

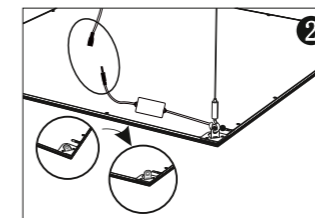

2. Upward hook on 4 corners, for suspending

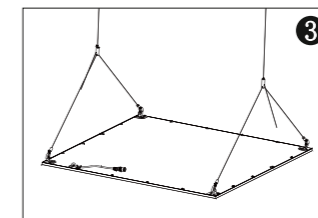

3. Finished installation

■ Panel 300x1200 600x1200

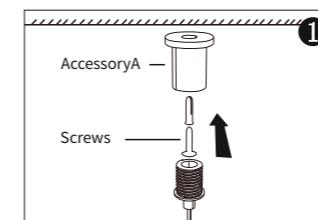

1. Screwing accessories A in ceiling

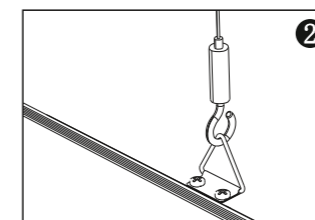

2. Triangle rings for hooks



3. Finished installation

Recessed Frame

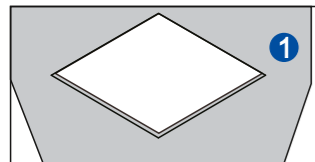

1. Open a hole on the ceiling.

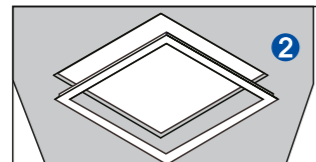

2. Fix the frame to the hole.

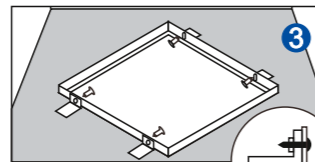

3. Fix the frame to the ceiling with the screws and "L" accessory.

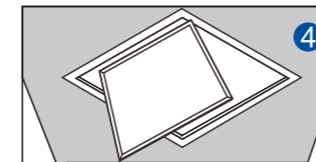

4. Put the panel into the frame.

Surface Mounted Frame

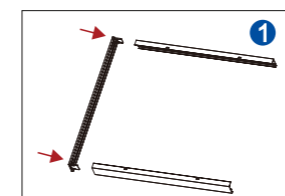

1. Assemble the 3 pieces of frame by metal bracket.

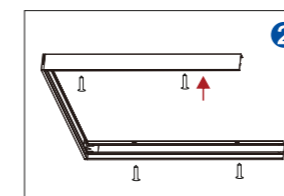

2. Fix the square frames in to ceiling with Screw.

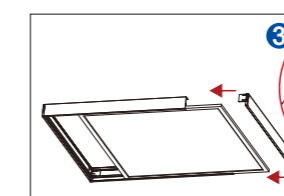

3. Insert the panel into frames and fix the cover plate frame.

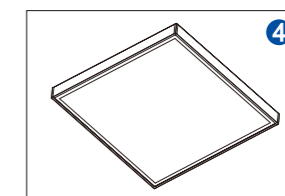

4. Finished frame installation.