

TUNOLA

LED T8 Tube 30W Max



Non-Flickering Version

LED T8 Tube is a cost-effective LED replacement for T8 fluorescent tubes and made by 6063 Aluminum shell with 6063 Aluminum shell and Anti UV PC (polycarbonate) cover
Fire Resistance UL94-V0 Material and comply Glow wire measuring wire 850°C. Integrated LED Driver

Technical Data

Cap base 燈腳 Base de la tapa	G13
Dimension-尺寸-Dimensión	<ul style="list-style-type: none"> • 2feet 588mm (602mm) 3feet 892mm (906mm) • 4feet 1198mm (1213mm) 5feet 1498mm (1513mm)
Input Voltage-輸入電壓-Voltaje de entrada	<ul style="list-style-type: none"> • AC100-240V 50/60Hz (Integrated LED Driver) • DC Version for dimming control : DALI, 0-10V , DMX and Zigbee
Power Consumption Max-燈具功率 Consumo de energía Max	<ul style="list-style-type: none"> • 6W @ 2 feet 8W @ 2 feet 9W @ 2 feet 10W @ 2 feet • 11W @ 3 feet 13W @ 3 feet • 14W @ 4 feet 16W @ 4 feet 18W @ 4 feet 20W @ 4 feet • 22W @ 5 feet 25W @ 5 feet 30W @ 5 feet
Power factor 功率因數 Factor de potencia	PF > 0.95
TOTAL HARMONIC DISTORTION 總諧波失真 DISTORSIÓN ARMÓNICA TOTAL	THD< 20%
Beam Angle光束角ángulo de haz	120°
Light Source Brand-光源品牌-Fuente de luz de marca	Everlight SMD
Photobiological safety-IEC 62471 / of Luminaire 光生物安全檢驗(ICE/EN 62471) 结果: Seguridad fotobiológica-IEC 62471	<ul style="list-style-type: none"> Low Risk Group 1 (RG1) 低風險組1 RG1 Grupo de bajo riesgo 1 (RG1)
Lumen Maintenance TM-21 L70 @ 25 °C 流明維持率(光通量衰減)報告: TM-21 L70 @ 25 °C Mantenimiento de lúmenes ITM-21 L70 @ 25 °C	L70 >54000 hours
Color Temperature -色溫 Temperatura del color	2700k 3000K 4000K 5000K 6000K 6500K
Color Rendering Index-顯色指數 Índice de reproducción cromática	> 80
MacAdam Ellipses Binning 麥克亞當橢圓分級 Mac Adam binning ellipse	<ul style="list-style-type: none"> Standard Deviation Colour Matching < 3 SDCM 標準偏差配色 < 3 SDCM Coincidencia de color estándar Desviación < 3 SDCM
Luminaire Efficacy 燈具效率 La eficacia de la luminaria	<p>Standard Series</p> <ul style="list-style-type: none"> • 110 Lm/w@ 2700K 110 Lm/w@ 3000K 120 Lm/w@ 4000K • 120 Lm/w@ 5000K 120 Lm/w@ 6500K <p>Advance Series</p> <ul style="list-style-type: none"> • 140 Lm/w@ 2700K 140 Lm/w@ 3000K 150 Lm/w@ 4000K • 160 Lm/w@ 5000K 160 Lm/w@ 6500K <p>Master Series</p> <ul style="list-style-type: none"> • 170 Lm/w@ 2700K 170 Lm/w@ 3000K 190 Lm/w@ 4000K • 200 Lm/w@ 5000K 200 Lm/w@ 6500K
Housing materials-外殼材料 Materiales de la carcasa	6063 Aluminum shell and Anti UV PC (polycarbonate) cover 6063鋁殼和抗紫外線PC 擴散罩 Carcasa de aluminio 6063 y cubierta de PC (policarbonato) anti UV
Housing Color外殼顏色color de la carcasa	Milky Diffuser 乳白色罩 Milky difusor
Ingress Protection-防護等級 Protección de ingreso	IP40
Operating Temperature Range / 工作溫度範圍 Rango de temperatura de funcionamiento	Rango de temperatura de funcionamiento -30 °C / +50 °C
Comply Testing Standard 符合測試標準 Cumplir el estándar de prueba	EN/IEC 60598-1 ; EN/IEC60598-2-1 ; EN / IEC 60598-2-2 TR62778 EN/IEC 62031; EN60838-2-2 ; EN 62493;EN/IEC 61347-1; EN/IEC 61347-2-13; IEC 62384 EMC EN55005 ;EN 61000-3-2 ;EN 61000-3-3; EN 61547 ; IEC62384 ; IEC 62560:2011;IEC 62612; IEC 62766-1; IEC 62766-2-1 ROHS ; TM21

Certification-認證-Certificación



Project	Fixture#	Date
		Firm



Ordering Information

Choose the option that suits your need and write its corresponding code on the appropriate line to form the product code.

Example product code: [TUNOLA-20W](#)

TUNOLA - - _____
 Power Consumption

Power Consumption	
Code	Description
6W	6W@2feet
8W	8W@2feet
9W	9W@2feet
10W	10W@2feet
11W	11W@3feet
13W	13W@3feet
14W	14W@4feet
16W	16W@4feet
18W	18W@4feet
20W	20W@4feet
22W	22W@5feet
25W	25W@5feet
30W	30W@5feet

Beam Angle

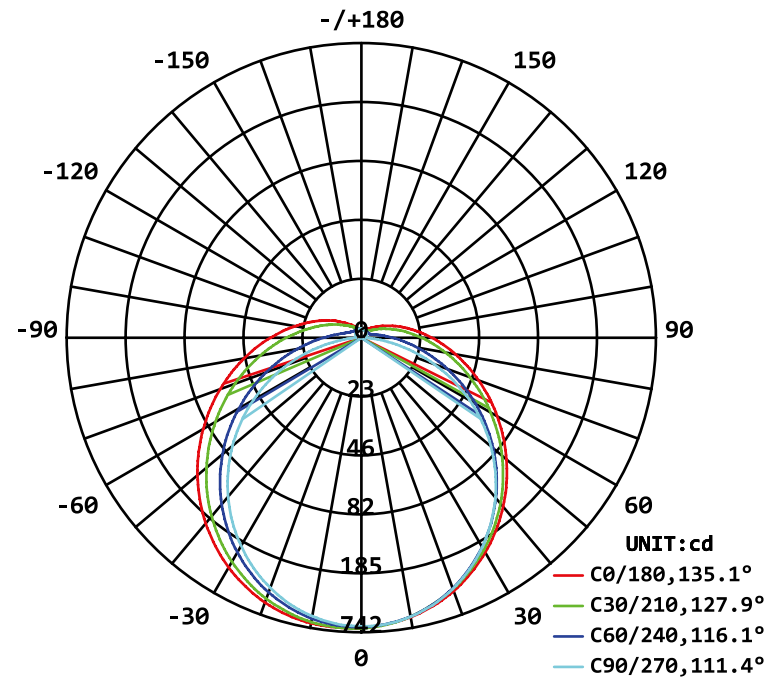

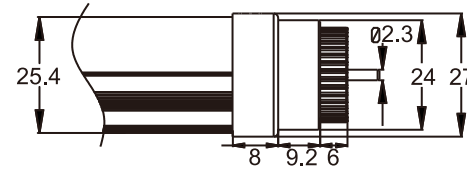
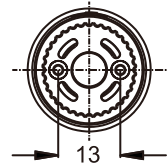
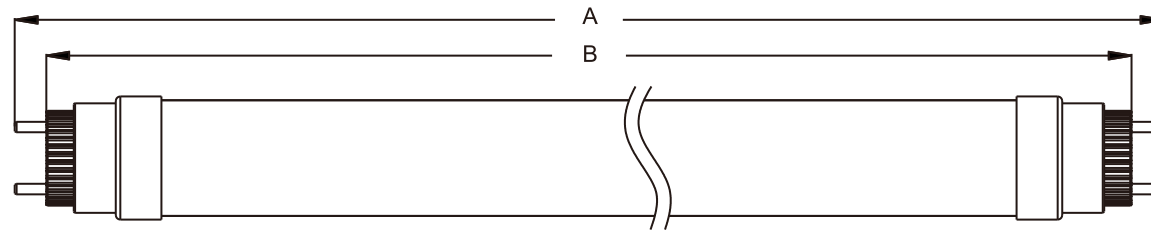

	2feet	3feet	4feet	5feet
	588 Dimension	892 Dimension	1198 Dimension	1498 Dimension
A:	602	906	1213	1513
B:	588	892	1198	1498

Unit: mm