





TUTA

LED T5 Tube 30W Max



LED T5 Tube is a cost-effective LED replacement for T5 fluorescent tubes and made by aluminum shell with PC cover. The luminaire is compatible with existing T5 installations in look and feel with far superior lighting performance.

Technical Data

Cap base / 燈腳 / Base de la tapa	G5
Dimension / 尺寸 / Dimensión	<ul style="list-style-type: none"> • 2 feet 548mm (562mm) 3 feet 848mm (862mm) • 4 feet 1148mm (1162mm) 5 feet 1448mm (1462mm)
Input Voltage / 輸入電壓 / Voltaje de entrada	<ul style="list-style-type: none"> • AC100-240V 50/60Hz • DC Input for Remoted LED Dimmable Driver: 1-10V / DALI / Zigbee Wireless
Power Consumption / 燈具功率 Consumo de energía Max	<ul style="list-style-type: none"> • 2 ft @ 7W 8W 9W 10W • 3 ft @ 13W 14W 15W • 4 ft @ 14W 15W 16W 18W 20W • 5 ft @ 22W 24W 26W 28W 30W
Power factor / 功率因數 / Factor de potencia	PF > 0.9
Total Harmonic Distortion / 總諧波失真 Distorsión armónica total	THD <20%
Beam Angle / 光束角 / ángulo de haz	120°
Light Source Brand / 光源品牌 Fuente de luz de marca	Everlight / Runlite
Photobiological safety (IEC 62471) 光生物安全檢驗(IEC 62471) Seguridad fotobiológica (IEC 62471)	<ul style="list-style-type: none"> Low Risk Group 1 (RG 1) 低風險組1 (RG 1) Grupo de bajo riesgo 1 (RG 1)
LED Life / LED壽命 / La vida del LED	>1000,000 hours
Lumen Maintenance TM-21 L70 流明維持率(光通量衰減)報告: TM-21 L70 Mantenimiento de lúmenes TM-21 L70	L70 >54,000 hours
Color Temperature / 色溫 Temperatura del color	• 2700k 3000K 4000K 5000K 6500K
Color Rendering Index / 顯色指數 Índice de reproducción cromática	> 80
MacAdam Ellipses Binning 麥克亞當橢圓分級 Mac Adam binning elipse	<ul style="list-style-type: none"> Standard Deviation Colour Matching < 3 SDCM 標準偏差配色 < 3 SDCM Coincidencia de color estándar Desviación < 3 SDCM
Luminaire Efficacy / 燈具效率 La eficacia de la luminaria	<p>Standard Series</p> <ul style="list-style-type: none"> • 110 Lm/w@ 2700K 120 Lm/w@ 3000K 130 Lm/w@ 4000K • 130 Lm/w@ 5000K 130 Lm/w@ 6500K <p>Advance Series</p> <ul style="list-style-type: none"> • 140 Lm/w@ 2700K 150 Lm/w@ 3000K 160 Lm/w@ 4000K • 160 Lm/w@ 5000K 160 Lm/w@ 6500K <p>High Efficiency Series</p> <ul style="list-style-type: none"> • 170 Lm/w@ 2700K 170 Lm/w@ 3000K 190 Lm/w@ 4000K • 200 Lm/w@ 5000K 200 Lm/w@ 6500K
Housing materials / 外殼材料 Materiales de la carcasa	6063 Aluminum shell and PC Cover / 6063鋁殼和PC罩 Cáscara de aluminio 6063 con cubierta de policarbonato.
Housing Color / 外殼顏色 color de la carcasa	Milky Diffuser / 乳白色罩 / Milky difusor
Weight / 重量 / Peso	• 175g @2feet 221g @3feet 276g @4feet 357g @5feet
Ingress Protection / 防護等級 Protección de ingreso	IP40
Operating Temperature Range / 工作溫度範圍 Rango de temperatura de funcionamiento	-20 °C / + 40 °C
Operating Humidity / 工作濕度 Humedad de funcionamiento	0~90%, non-condensing / 不結霜 sin condensación
Comply Testing Standard / 符合測試標準 Cumplir el estándar de prueba	EN/IEC 60598-1 ; EN/IEC60598-2-1 ; EN / IEC 60598-2-2 TR62778 EN/IEC 62031; EN60838-2-2 ; EN 62493;EN/IEC 61347-1; EN/IEC 61347-2-13; IEC 62384 EMC EN55005 ; EN 61000-3-2 ;EN 61000-3-3; EN 61547 ; IEC62384 ; IEC 62560:2011;IEC 62612; IEC 62766-1; IEC 62766-2-1 ROHS ; TM21
Certification / 認證 / Certificación	    

Project	Fixture#	Date
		Firm



Ordering Information

Choose the option that suits your need and write its corresponding code on the appropriate line to form the product code.

Example product code: [TUTA-18W](#)

TUTA - - _____
Power Consumption

Power Consumption	
Code	Description
7W	7W @ 2 feet
8W	8W @ 2 feet
9W	9W @ 2 feet
10W	10W @ 2 feet
12W	12W @ 3 feet
13W	13W @ 3 feet
14W	14W @ 3 feet & 4 feet
15W	15W @ 3 feet & 4 feet
16W	16W @4 feet
18W	18W @ 4 feet
20W	20W @ 4 feet
22W	22W @ 5 feet
24W	24W @ 5 feet
26W	26W @ 5 feet
28W	28W @ 5 feet
30W	30W @ 5 feet

Technical Drawing

	2feet	3feet	4feet	5feet
	548 Dimension	848 Dimension	1148 Dimension	1448 Dimension
A:	562	862	1162	1462
B:	548	848	1148	1448

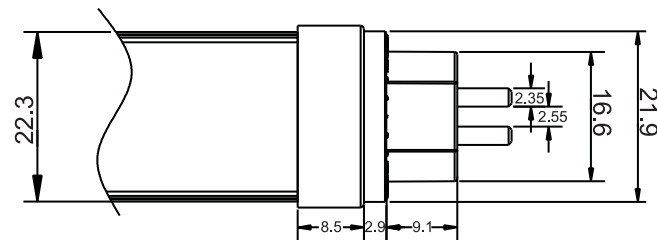
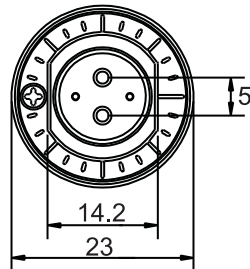
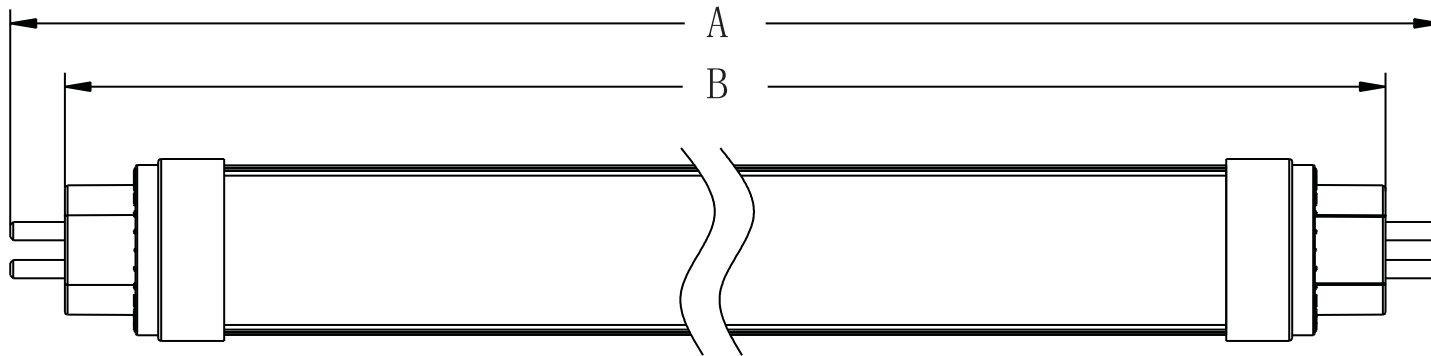

Unit: mm

BEAM ANGLE

